

ALDOX

FRAME PRO FILES

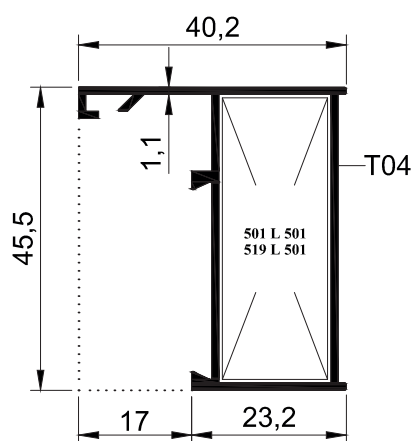

A45 J 01 - 0.460 kg/mt

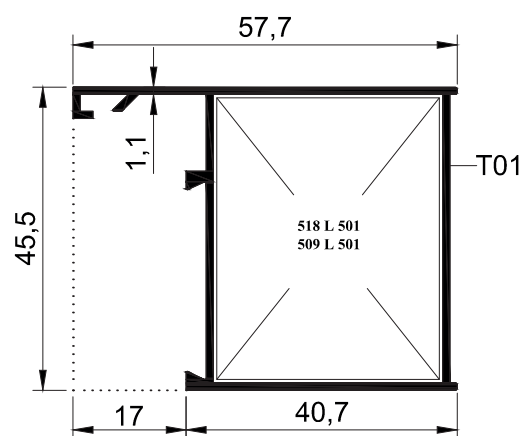

A45 J 02 -1.1mm.-0.620 kg/mt

A45 J 02 -1.5mm.-0.660 kg/mt

A45 J 02 -2.0mm.-0.982 kg/mt

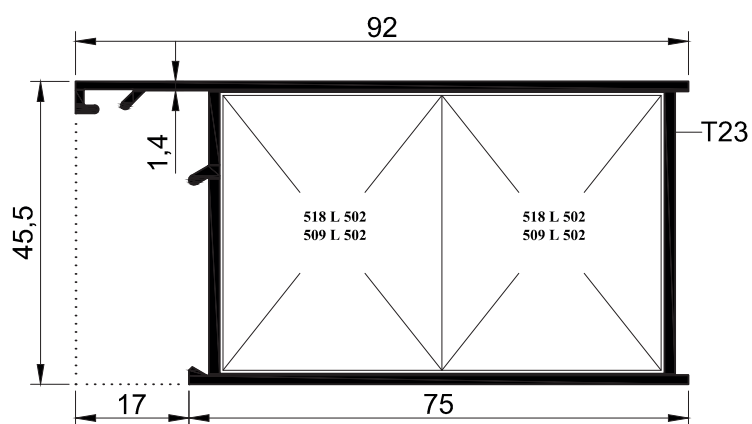

A45 J 03 -1.163 kg/mt

| Profile Code | Corner Pr. Code | CUTTING MEAS. mm | Accessory Code |
|--------------|-----------------|------------------|----------------|
| A45 J 01 | L 501 | 43,0 | 501 L 501 |
| | L 519 | 43,0 | 519 L 501 |
| A45 J 02 | L 509 | 43,0 | 509 L 501 |
| | L 518 | 43,0 | 518 L 501 |
| A45 J 03 | L 509 | 42,0 | 509 L 502 |
| | L 518 | 42,0 | 518 L 502 |

VENT PROFILES

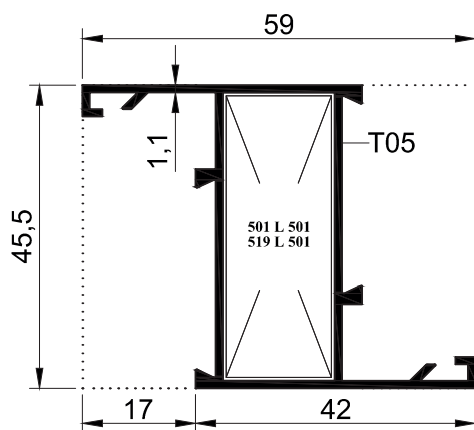

A45 Z 01 - 0.600 kg/mt

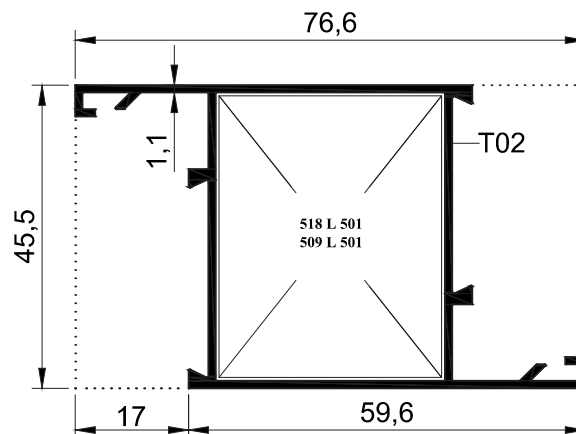

A45 Z 02 -1.1mm.-0.680 kg/mt

A45 Z 02 -1.5mm.-0.893 kg/mt

A45 Z 02 -2.0mm.-1.098 kg/mt

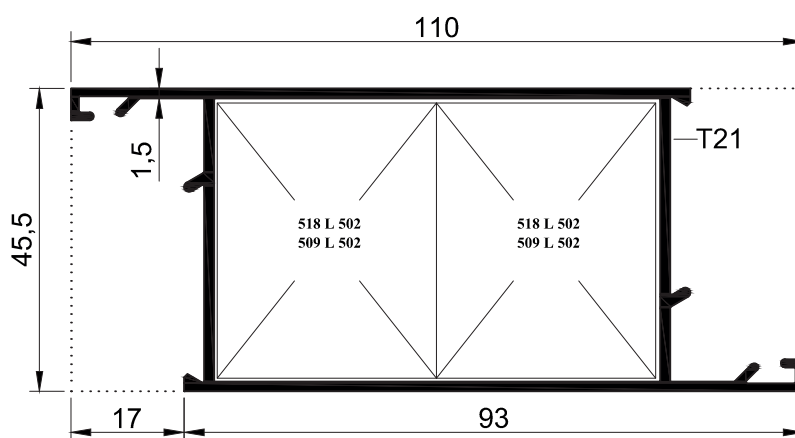

A45 Z 03 - 1.265 kg/mt

| Profile Code | Corner Pr. Code | CUTTING MEAS. mm | Accessory Code |
|--------------|-----------------|------------------|----------------|
| A45 Z 01 | L 501 | 43,0 | 501 L 501 |
| | L 519 | 43,0 | 519 L 501 |
| A45 Z 02 | L 509 | 43,0 | 509 L 501 |
| | L 518 | 43,0 | 518 L 501 |
| A45 Z 03 | L 509 | 42,0 | 509 L 502 |
| | L 518 | 42,0 | 518 L 502 |

MULLION PROFILES

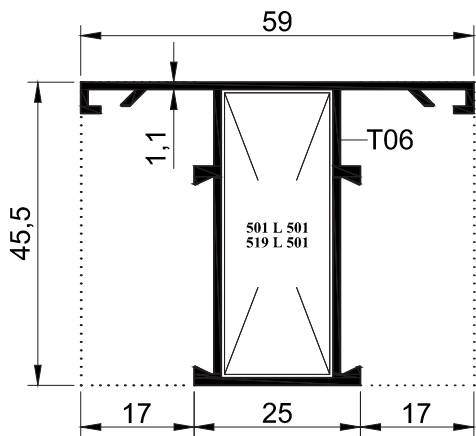

A45 T 01 - 0.600 kg/mt

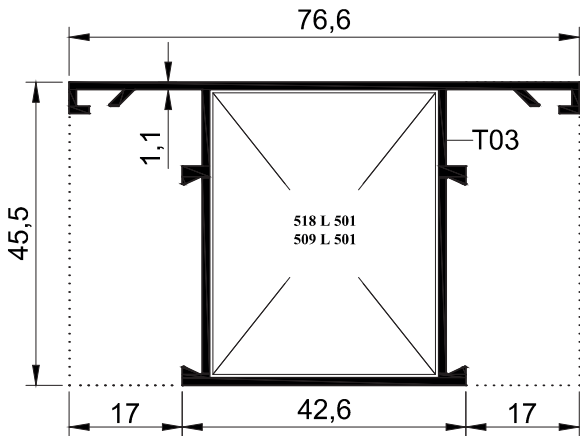

A45 T 02 -1.1mm.-0.680 kg/mt
A45 T 02 -1.5mm.-0.893 kg/mt
A45 T 02 -2.0mm.-1.098 kg/mt

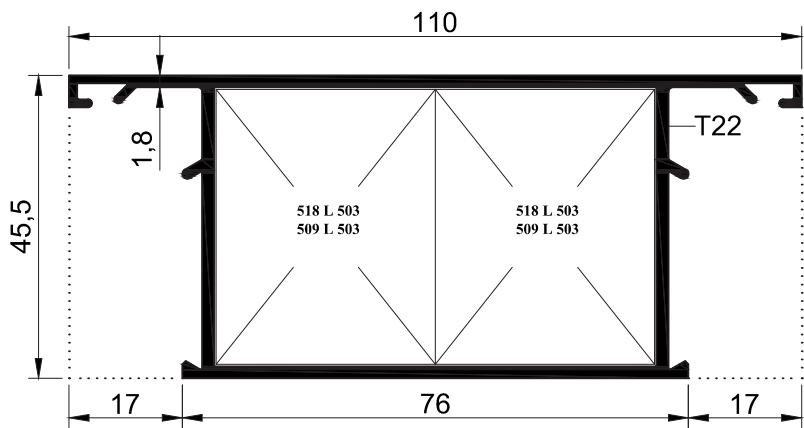

A45 T 03 - 1.340 kg/mt

| Profile Code | Corner Pr. Code | CUTTING MEAS. mm | Accessory Code |
|--------------|-----------------|------------------|----------------|
| A45 T 01 | L 501 | 43,0 | 501 L 501 |
| | L 519 | 43,0 | 519 L 501 |
| A45 T 02 | L 509 | 43,0 | 509 L 501 |
| | L 518 | 43,0 | 518 L 501 |
| A45 T 03 | L 509 | 41,5 | 509 L 503 |
| | L 518 | 41,5 | 518 L 503 |

SYSTEM PROFILES

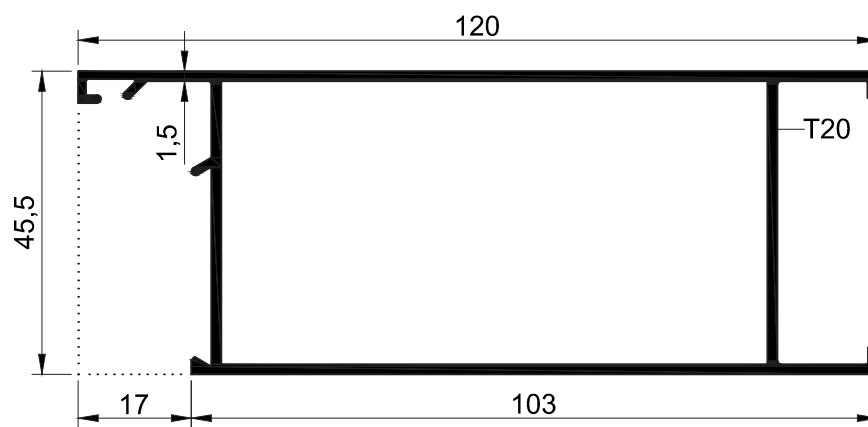

A45 Y 01 - 1.450 kg/mt

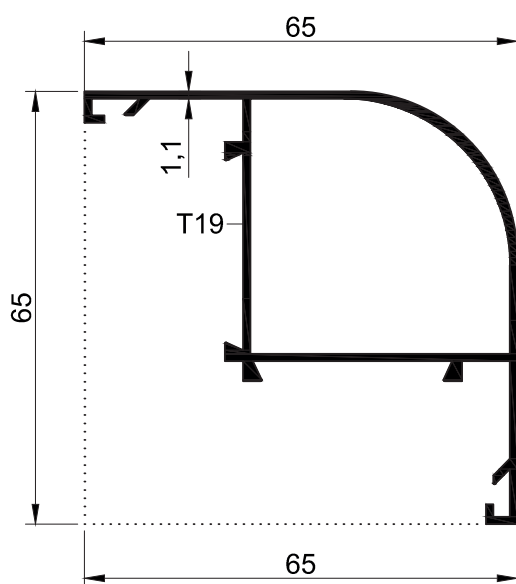

A45 K 01 - 0.780 kg/mt

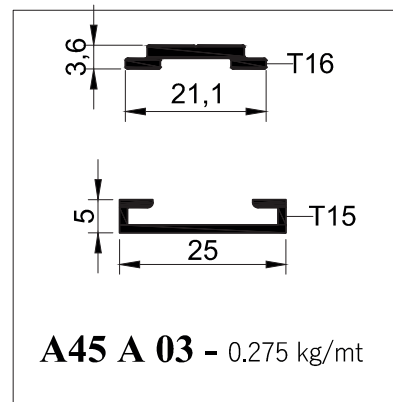

A45 A 03 - 0.275 kg/mt

SYSTEM PROFILES



A45 A 01 - 0.320 kg/mt



A45 A 02 - 0.340 kg/mt

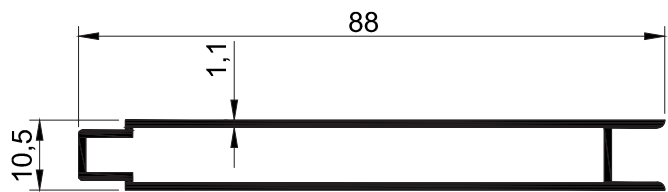

T17 - 0.655 kg/mt

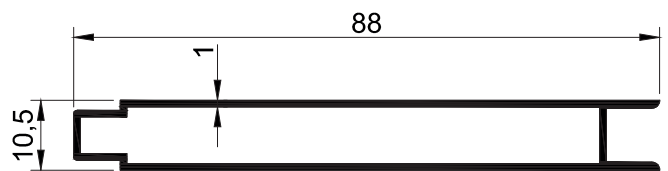

T17-1 - 0.545 kg/mt

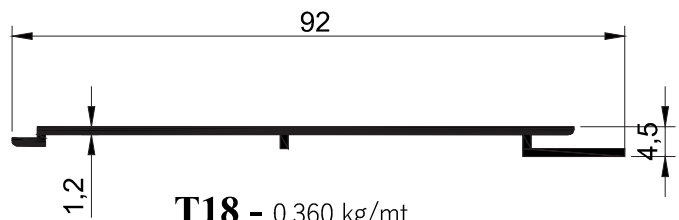

T18 - 0.360 kg/mt

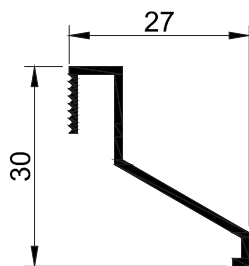

T28 - 0.200 kg/mt

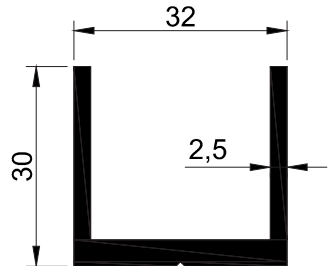

T53 - 0.620 kg/mt

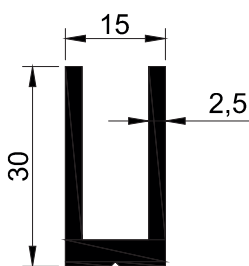

T54 - 0.523 kg/mt

GLAZING BEAD PROFILES

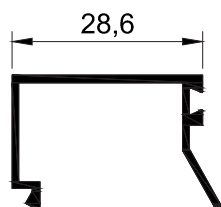

T13 - 0.205 kg/mt

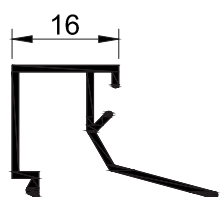
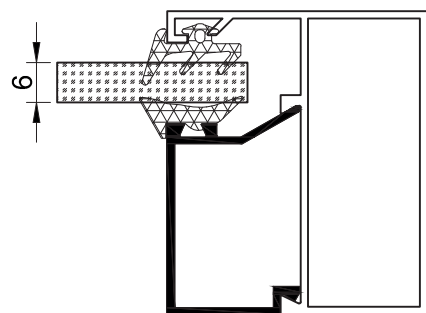
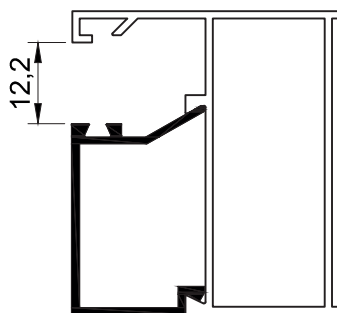

T14 - 0.215 kg/mt

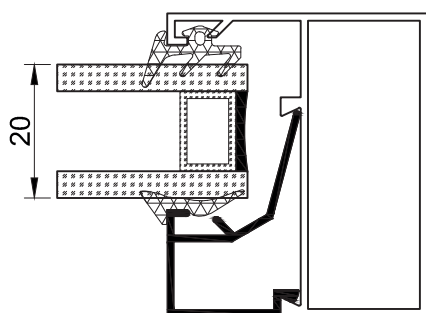
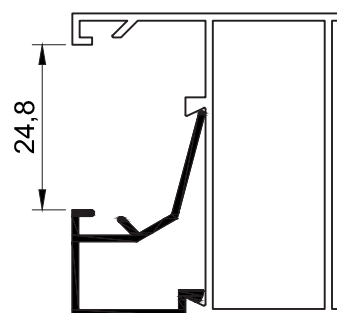

CONNECTION PROFILES

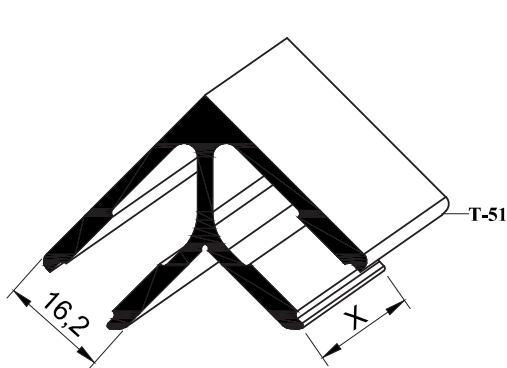

L519 - 0.620 kg/mt

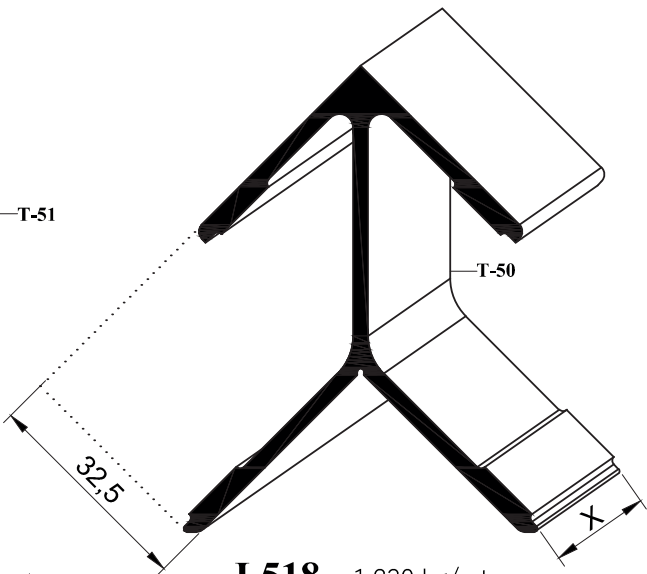

L518 - 1.230 kg/mt

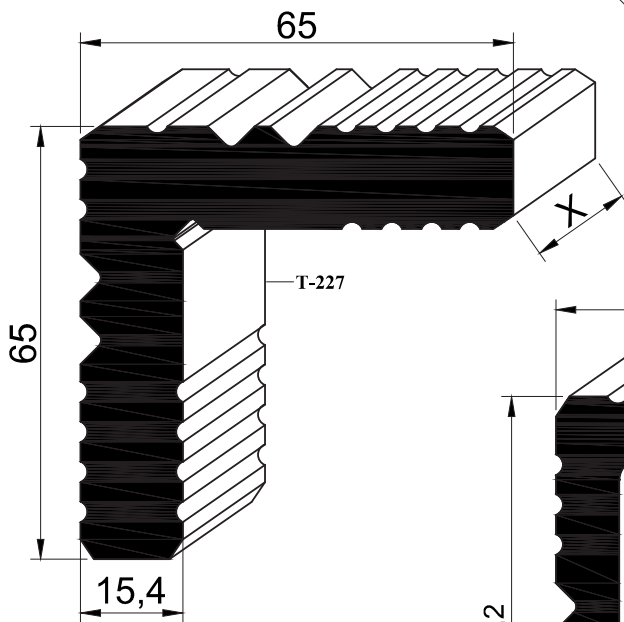

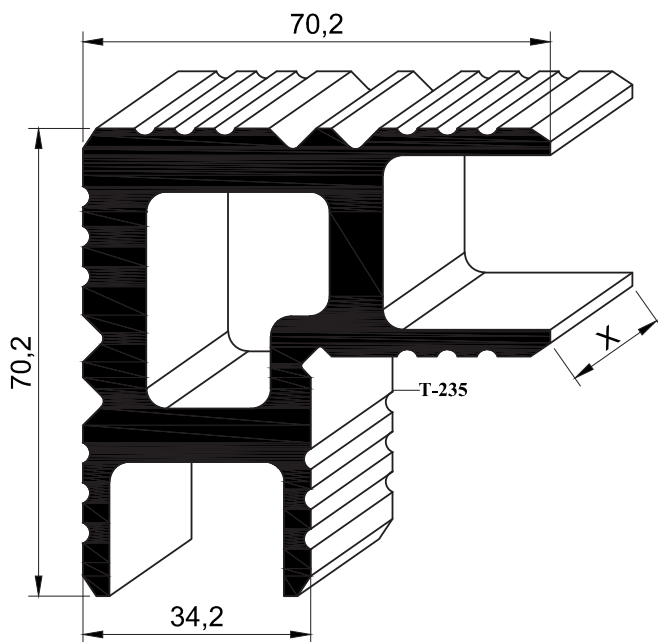

L501 - 4.460 kg/mt











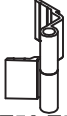

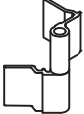
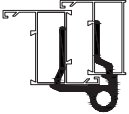

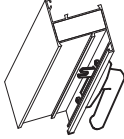

L509 - 4.300 kg/mt

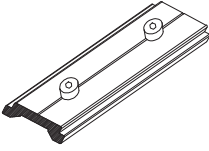

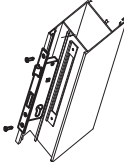

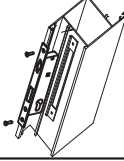

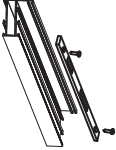
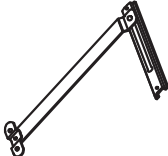
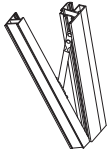

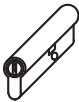
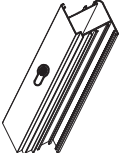

CONNECTION CUT MEASUREMENTS

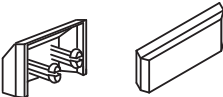
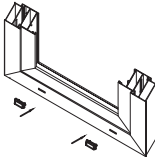
| Profile Code |  Corner PR.Code | CUTTING MEAS. mm |  Accessory Code |
|-----------------|--|---------------------|---|
| A45 J 01 | L 501 | 43,0 | 501 L 501 |
| | L 519 | 43,0 | 519 L 501 |
| A45 J 02 | L 509 | 43,0 | 509 L 501 |
| | L 518 | 43,0 | 518 L 501 |
| A45 J 03 | L 509 | 42,0 | 509 L 502 |
| | L 518 | 42,0 | 518 L 502 |
| A45 Z 01 | L 501 | 43,0 | 501 L 501 |
| | L 519 | 43,0 | 519 L 501 |
| A45 Z 02 | L 509 | 43,0 | 509 L 501 |
| | L 518 | 43,0 | 518 L 501 |
| A45 Z 03 | L 509 | 42,0 | 509 L 502 |
| | L 518 | 42,0 | 518 L 502 |
| A45 T 01 | L 501 | 43,0 | 501 L 501 |
| | L 519 | 43,0 | 519 L 501 |
| A45 T 02 | L 509 | 43,0 | 509 L 501 |
| | L 518 | 43,0 | 518 L 501 |
| A45 T 03 | L 509 | 41,5 | 509 L 503 |
| | L 518 | 41,5 | 518 L 503 |

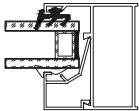
SYSTEM ACCESSORIES

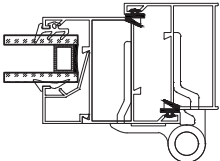
| DROWING | CODE | PLACE OF APPLICATION |
|--|---|---|
|  T56-T57 | Aldox SZ Hinge SZA 10103001 |  |
|  T58-T59 | Aldox Hingg With Joint SZA 10105001 |  |
|  | Axiol Handle SZA 09108001 |  |
|  | Adjusted Countes SZA 52012001 |  |
|  | Rod Pin SZA 16007020 SZA 16007001 |  |
|  | Mortise Lock 25 mm. SZA 20111225 |  |
|  | Mortise Lock With Roller 25 mm. SZA 20112225 |  |
|  | Striker Mortise Lock SZA 12101001 Striker Roller Lock SZA 12102001 |  |
|  | Transom Scissor SZA 58110001 SZA 58111301 |  |

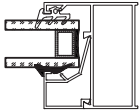
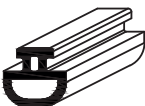
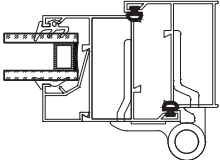
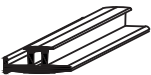
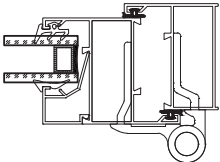
SYSTEM ACCESSORIES

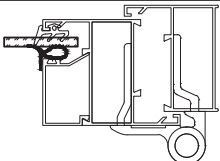
| DROWING | CODE | PLACE OF APPLICATION |
|---|---|--|
|  | Cylinder SZA 18102090 |  |
|  | Savio Slide SZA 14101001 SZA 14102001 |  |
|  | Drain Cover SZA 16009001 |  |
|  | SZ-N1 Outer Glass Gasket SZA 26570001 |  |
|  | SZ-N2 Wing Gasket SZA 26570002 |  |
|  | Inner Glass Gasket SZA 26520001- 1mm SZA 26520002- 2 mm SZA 26520003- 3 mm SZA 26520004- 4 mm SZA 26520005- 5 mm SZA 26520006- 6 mm |  |
|  | SI-4.2 Wing Gasket |  |
|  | Aldox Wing Gasket SZA 26020001 SZA 26020002 |  |
|  | Hose Gasket SZA 26530003- 3 mm SZA 26530004- 4 mm SZA 26530006- 6 mm |  |

ALDOX SYSTEM INSTALLATION DETAIL

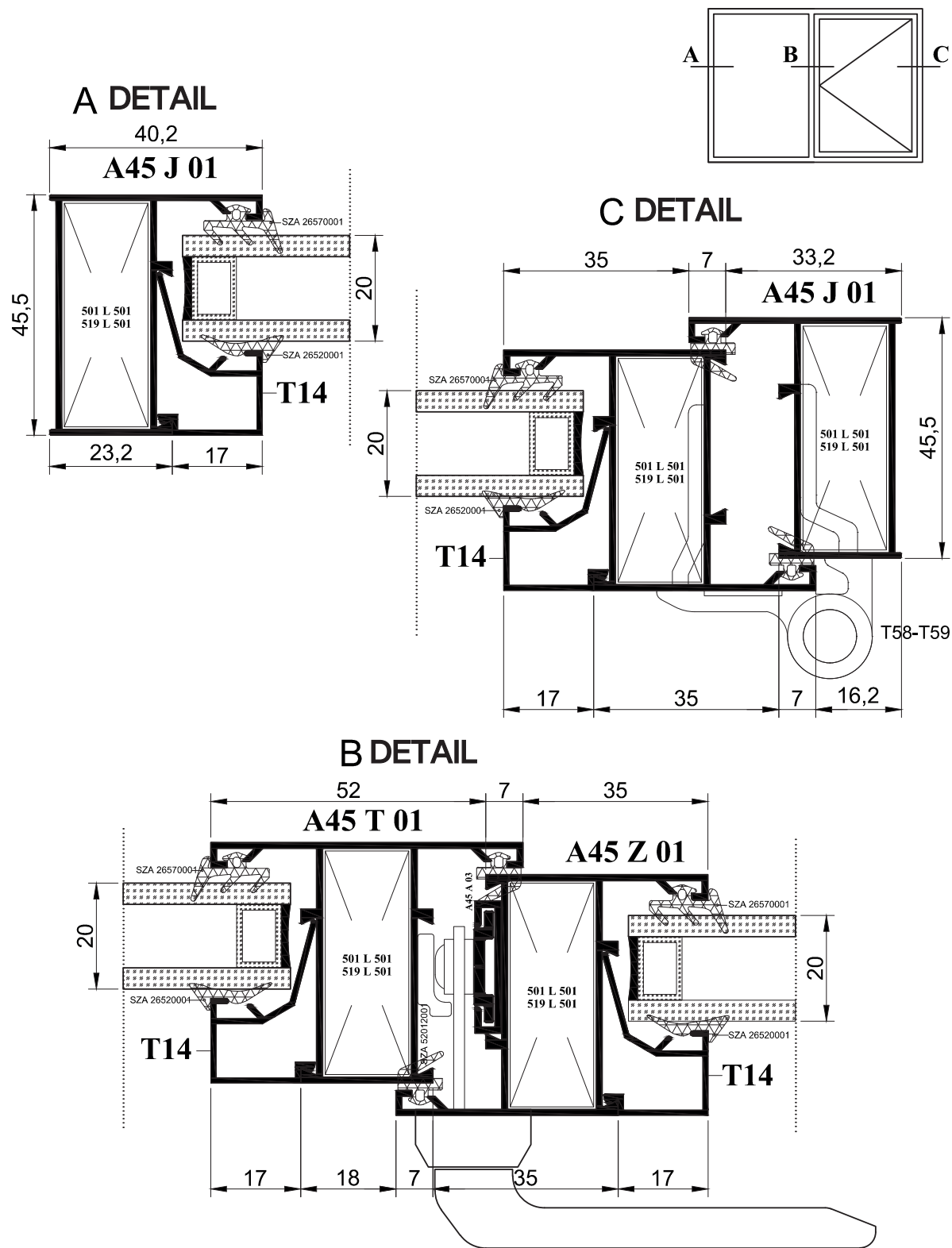

ALDOX SYSTEM INSTALLATION DETAIL

