

PSX-300DP

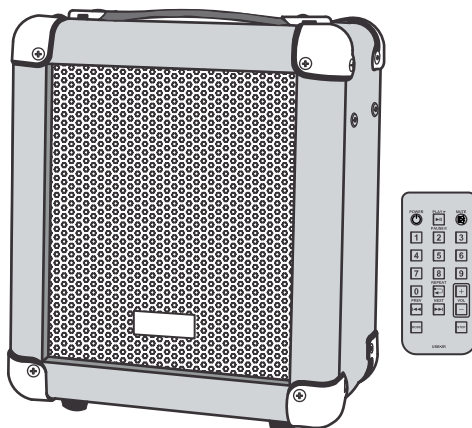

FEATURES

- Designed for Portable PA applications.
- Two Mic and one Aux inputs.
- Built-in 6.5"/6Ω Dual Cone Speaker.
- Built-in MP3 Player.
- Tone control for proper shaping of frequency levels.
- A Clip LED to monitor the output and to caution overdrive.
- Operation on AC mains or 12V DC power source (car battery) or 8×1.5V UM-1 cells.

-
- ◆ Thank you for purchasing the Portable PA Amplifier System.
 - ◆ Please read this manual thoroughly before making connections and turning on the power. Following the instructions in this manual will enable you to obtain optimum performance from your new Portable PA Amplifier System.
 - ◆ Please retain this manual for future reference.

• Top Panel Controls & Description

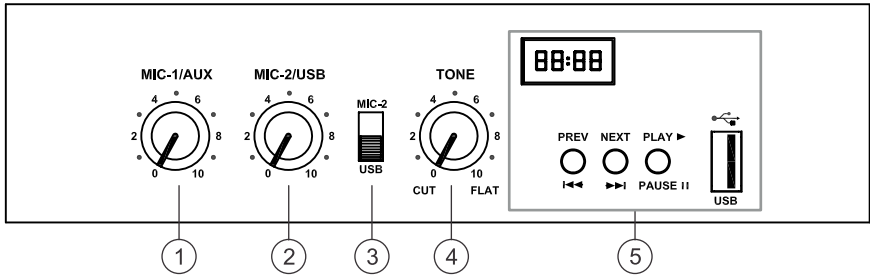

1. **MIC-1/AUX Volume Control**
2. **MIC-2/USB Volume Control**
3. **MIC-2/USB Switch**
4. **TONE Control:** For attenuating the signal level of high frequencies.
5. **MP3 Playback Facility**
 - a. **PREV** ◀◀: To select the previous track.
 - b. **NEXT** ▶▶: To select the next track.
 - c. **PLAY** ▶ / **PAUSE II**: Press Play/Pause once to Pause when music is already playing. Press Play/Pause again to resume playing.
 - d. **Display:** Displays the track played.
 - e. **USB Connector:** Insert the USB drive here.

• Rear Panel Controls & Description

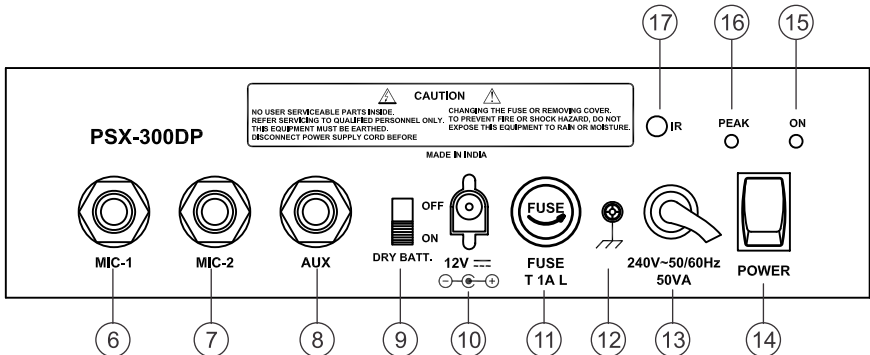

6. **MIC-1 Input Jack Socket**
7. **MIC-2 Input Jack Socket**
8. **AUX Input Jack Socket:** For accepting a signal from an auxiliary source like CD Player, Keyboard, Echo Mixer etc.
9. **Dry Battery Switch:** Switch this to ON side when using Dry Cells.
10. **Battery Socket:** For connecting 12V Car Battery as standby power source.
11. **AC Mains Fuse Rating 1 AMP 250V (T 1 AL):** This protects the amplifier from any excessive current flow.
12. **Earth Terminal**
13. **2 Core AC Mains Cable with Plug**
14. **POWER Switch:** Press the lower part of the knob to switch power ON.
15. **Power LED**
16. **CLIP LED:** This LED glows when the output is at clipping level. Reduce the level controls to ensure this LED is not continuously glowing.
17. **IR Sensor:** Point the remote control towards this for satisfactory reception of remote control commands.

• Operation & Interconnections

Remote Control

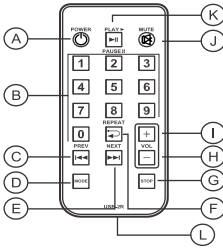

- A. **Power:** Press once to switch off MP3 digital player, press again to switch ON.
- B. **Number key 0 to 9.** To select the track number to be played.
- C. **◀◀:** To select the previous track.
- D. **MODE:** not in use.
- E. **▶▶:** Press to select the next track.
- F. **↻** Press once to repeat the song being played. Press again to repeat all the songs.

- G. **STOP:** Press to stop the track being played.
- H. **Vol-:** Press to decrease the volume of Digital Player.
- I. **Vol+:** Press to increase the volume of Digital Player.
- J. **MUTE:** Press once to mute the sound, press again to resume the sound.
- K. **▶/PAUSE:** Press Play/Pause once to Pause when music is already playing. Press Play/Pause again to resume playing.
- L. **Battery Replacement:** Pull out the battery tray and replace the battery with positive electrode facing upwards as shown in fig. below. Push the battery compartment back to the close position. Use CR2025 or equivalent lithium coin cell.

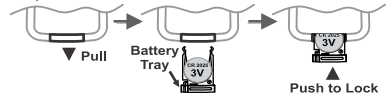

Rear Panel

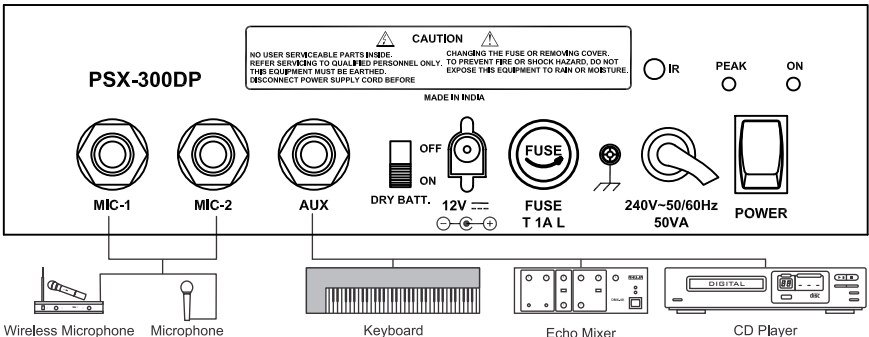

- Make necessary interconnections with the powered speaker and set all the volume controls to '0' position.
- Plug in the AC power cord to the nearest AC mains socket and turn the power switch 'ON'.
- Glow of red LED indicates that power is ON and the set is ready for operation.
- Set the desired Input level controls for optimum listening level.
- Set the tone control to the desired level.
- Continuous glow of the clip LED indicates that signal level is excessive. Set the level

controls so that the clip LED does not glow continuously.

- The unit may also be connected to a 12V car battery as a standby power source. In case of mains failure automatic change over to battery operation gives smooth functioning of the programme.
- In case 240V mains or 12V car battery are not available the set can also be operated on 8×UM-1 cells. Insert the cells after unscrewing the 4 moulded screws on the rear panel shown below. Put DRY BATT. switch to ON position.

NOTE: When dry cells are not used put DRY Batt. switch to OFF position.

• Safety Instructions

Water and Moisture:

In order to prevent any fire or shock hazard, do not expose this equipment to rain or moisture.

Power Source:

The equipment should be connected to a 220-240V 50Hz AC or 12V DC power source or with 8×UM-1 cells.

Power-cord Protection:

Do not cut, kink, damage or modify the power supply cord supplied with the equipment. Keep the power supply cord away from heaters & harmful chemicals. Do not place heavy objects on the power cord.

Operation on Generator:

When operating the powered speaker on a generator, make sure it is switched 'OFF' till the generator voltage has stabilized and then only switch the powered speaker 'ON'.

Protection Against Shocks:

Do not plug in or remove the power supply plug with wet hands so as to avoid electric shock.

Replacing AC Mains Fuse:

After disconnecting the AC mains and rectifying the defect in the amplifier, change the fuse with another of the specified rating only.

Grounding or Earthing:

The equipment must be earthed properly before operating it to avoid electric shock. A wire from the Earth Terminal must be connected to either water pipe or to electrical earth for safe operation.

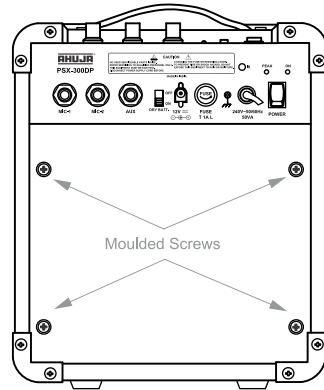

• Specifications

Power Output	20W Max 15W RMS at 10% THD 13W RMS at 5% THD
Input Channels	2 × Mic 1.5mV/4.7kΩ 1 × Aux 100 mV/330kΩ
Frequency Response	120-15,000Hz ±3dB
S/N Ratio	60dB
Tone Controls	-10dB at 10kHz
MP3 Playback	MP3 (FAT 32 Format) Port: USB-A (Full speed)
Built-in Speaker	6.5"/6Ω Dual Cone Speaker
Protections	AC Fuse: 1 Amp. 250V T 1A L, DC Fuse: (T 4A L)
Power Supply	AC : 220V-240V 50/60Hz DC : 12V Car Battery 8×UM-1 Cells
AC Power Consumption	50VA
Dimensions	W245 x H295 x D175 mm
Weight	5.70 kg