

Please read this guide first!

Our valued customer,

Please read this manual before using the product.

Thank you for choosing this product. We want your product, produced with high quality and technology, to offer you the best efficiency. Therefore, read this entire manual and other supplied documents carefully before using the product.

Take into account all information and warnings specified in the user manual. In this way, you can protect yourself and your product against possible dangers. Keep the user manual. If you give the product to someone else, give the user manual along with it.

The following symbols appear in the user manual and on the product:

ANNOUNCEMENT



Danger that could result in death or injury.

ANNOUNCEMENT



Risk of electric shock!

WARNING



Important information or helpful tips on usage.

ATTENTION



Read the user manual.

DANGER



Combustible material, warning of fire hazard.

DANGER



Danger that may result in burns due to contact with hot surfaces.

Safety Instructions

- This section contains safety instructions that will help prevent personal injury or property damage.
- Our company cannot be held responsible for any damages that may occur if these instructions are not followed.

ANNOUNCEMENT



Always have installation and repairs carried out by the manufacturer or authorized service.

ANNOUNCEMENT



Use only original spare parts and accessories.

ANNOUNCEMENT



Do not repair or replace any part of the product unless expressly stated in the user manual.

ANNOUNCEMENT



Do not make technical changes to the product.

Additional Information

- ↪ [Purpose of usage](#)
 - ↪ [Child, Vulnerable Person and Pet Safety.](#)
 - ↪ [Electrical Safety.](#)
 - ↪ [Transportation Security.](#)
 - ↪ [Installation Security.](#)
 - ↪ [Usage Safety.](#)
 - ↪ [Food Storage Safety.](#)
 - ↪ [Maintenance and Cleaning Safety.](#)
 - ↪ [Disposal of the Old Product](#)
-

Purpose of usage

- This product is not suitable for commercial use and should not be used for purposes other than its intended use.
- This product is designed to be used indoors, at home and similar places.

For example;

In staff kitchens of stores, offices and other work environments,

In farmhouses,

In the environments used by customers of hotels, motels and other accommodation facilities,

In hostel type environments,

In food service and similar non-retail applications.

- The product should not be used on a boat, in a caravan, or in open or closed outdoor spaces such as balconies or terraces.
Exposing the product to rain, snow, sun and wind may create a fire risk.
-

Child, Vulnerable Person and Pet Safety

- This product can be used by children aged 8 and over and by persons whose physical, sensory or mental capabilities are not fully developed or who lack experience and knowledge, as long as they are supervised or trained about the safe use of the product and its risks.
 - Children between the ages of 3 and 8 are allowed to load and unload the refrigerator.
 - Electrical products are dangerous to children and pets. Children and pets should not play with, climb on, or climb into the product.
 - Children and pets should be kept away from the bottom of the cabin (compressor) area where the electrical parts are located.
 - Cleaning and user maintenance operations should not be carried out by children unless they are supervised by someone.
 - Keep packaging materials away from children. There is a risk of injury and suffocation.
-

Electrical Safety

- The product should not be plugged into the socket during installation, maintenance, cleaning, repair and transportation operations.

If the power cable is damaged, it must be replaced by an authorized service in order to prevent possible dangers.

- Do not pinch the power cord under or behind the product. Do not place a heavy object on the power cord. The power cable should not be excessively bent, crushed or come into contact with any heat source.
 - Do not use an extension cord, multiple socket or adapter to operate the product.
 - Portable power strips or portable power supplies can overheat and cause a fire. For this reason, do not place multiple sockets or portable power sources behind or near the product.
 - Do not plug the product into a loose or damaged socket. These types of connections may overheat and cause fire.
 - The plug must be in an easily accessible place. If this is not possible, there must be a mechanism (fuse, switch, switch, etc.) on the electrical installation to which the product is connected, that complies with electrical regulations and separates all poles from the network.
 - Do not touch the plug with wet hands.
 - When unplugging, pull the plug, not the cable.
-

Transportation Security

- Unplug the product before moving it.
 - The product is heavy, do not carry it alone. If the product falls on you, it may cause injury. Do not hit or drop the product while carrying it.
 - When carrying the product, always close its doors and do not hold it by the doors.
 - Be careful not to damage the cooling system and pipes during transportation of the product. If the pipes are damaged, do not operate the product and call the authorized service.
-

Installation Security

- Call the Authorized Service to install the product. To make the product ready for use, make sure that the electrical and plumbing systems are suitable by referring to the information in the user manual. If the installation is not suitable, call a licensed electrician and plumber to make the necessary arrangements. Otherwise, electric shock, fire, product problems or injury may occur.
 - This product is designed for use at an altitude of up to 2000 meters above sea level.
 - Before installing the product, check for any damage. If the product is damaged, do not install it!
 - Be sure to use personal protective equipment (gloves, etc.) when installing, maintaining and repairing the product. Risk of injury!
 - Place the product on a clean, flat and hard surface and balance it with the adjustable feet (turning the front feet to the right or left). Otherwise, the refrigerator may topple over and cause injury.
 - The place where the product will be installed must be dry and ventilated. There should be no carpets, rugs or similar covers under the product. There may be a risk of fire due to insufficient ventilation!
 - Do not block the front or top of the ventilation holes. Otherwise, energy consumption will increase and damage to your product may occur.
 - When placing the product, make sure that the supply cable is not damaged or pinched.
 - The product should not be connected to power supply systems such as solar energy power sources. Otherwise, your product may be damaged due to sudden voltage changes!
 - The more refrigerant a refrigerator contains, the larger the location it should be installed in. In very small spaces, if there is a gas leak in the cooling system, a flammable gas-air mixture may form. The volume of space required for every 8 grams of refrigerant gas is at least 1 m³. The amount of refrigerant gas in your product is written on the Type Label.
 - The place where the product is installed should not be exposed to direct sunlight and should not be exposed to stove, radiator etc. It should not be near a heat source such as If it cannot be avoided to install the product near the heat source, a suitable insulation plate must be used or the minimum distance to the heat source must be as follows:
 - At least 30 cm away from heat sources such as stove, oven, heating unit and stove,
 - At least 5 cm away from electric ovens.
 - Your product is a protection class type I device.
 - Connect the product to a grounded socket suitable for the Voltage, Current and Frequency values specified on the type label. The socket must have a fuse rated at 10A – 16A. Our company will not be responsible for any damages that may occur if the product is used without grounding and electrical connection in accordance with local and national regulations.
 - The product's power plug should not be plugged into the socket during installation. Otherwise there is a risk of electric shock and injury!
 - Do not plug the product into sockets that are loose, disconnected, broken, dirty, oily or at risk of contact with water. Such connections may cause overheating and fire.
 - Place the product power cable and hoses (if any) in a way that does not pose a tripping hazard.
 - Moisture or liquid penetration into live parts or the power cord may cause a short circuit. Therefore, do not use the appliance in damp or water-splashed areas (e.g. garage, laundry room). If the refrigerator gets wet with water, unplug the power cord and call the authorized service.
 - Never connect your refrigerator to electricity saving devices. Such systems are harmful to the product.
 - There is a danger of contact with electrical parts when the electronic card cover and compressor rear cover (if included in the product) are removed. Do not disassemble the product's card cover or compressor rear cover (if present on the product). There is a risk of electric shock!
-

Usage Safety

- Never use chemical solvents on the product. These substances carry the risk of explosion.
- In case of a malfunction in the product, unplug the product and do not operate it until it is repaired by the authorized service. There is a risk of electric shock!
- Do not place flame sources (e.g. candles, cigarettes) on or near the product.
- Do not climb onto the product. Risk of falling and injury!
- Do not damage the cooling system pipes using cutting or piercing tools. If gas pipes, pipe extensions or surface coatings are punctured, the refrigerant that will spray out will cause skin irritation and eye injuries.
- Do not place or use electrical appliances in the refrigerator/freezer unless recommended by the manufacturer.
- Be careful not to trap any part of your hands or body in the moving parts inside the product. Be careful not to get your fingers caught between the door and the cabinet. If there are children around, be careful when opening and closing the door.
- Never put ice creams, ice cubes and frozen foods into your mouth immediately after taking them out of the freezer. There is a risk of frostbite!
- Do not touch the inner walls of the freezer, metal parts or products stored in the freezer with wet hands. There is a danger of frostbite!
- Do not place cans and bottles containing carbonated drinks or liquids that may freeze in the freezer compartment. Cans or bottles may explode. There is a risk of injury and material damage!
- Do not use or place temperature-sensitive substances such as flammable sprays, flammable objects, dry ice or other chemicals near the refrigerator. There is a risk of fire or explosion!
- Do not store explosive materials, such as aerosol cans containing flammable materials, inside your product.
- Do not place containers containing liquids uncovered on the product. Splashing water on an electrical part may cause electric shock or fire hazard.
- This product is not suitable for the storage and cooling of medicines, blood plasma, laboratory preparations or similar substances and products subject to the Medicinal Products Directive.
- If the product is used contrary to its intended purpose, it may cause damage or deterioration of the products stored inside.
- If your refrigerator has Blue light, do not look at this light with optical instruments. Do not look directly at the UV LED lamp for a long time. Ultraviolet rays can cause eye strain.
- Do not fill the product beyond its capacity. Injuries or damage may occur if the contents of the refrigerator fall when the door is opened. Similar problems may occur when any object is placed on the product.
- Be sure to remove any ice or water that may have fallen on the floor to avoid injury.
- Replace the shelves/bottle shelves on the door of your refrigerator only when the shelves are empty. There is a risk of injury!
- Do not place anything on the product that could fall/topple over. When opening and closing the door, objects may fall and cause injury and/or property damage.
- Do not hit or apply excessive force to glass surfaces. Glass breakage may result in personal injury and/or property damage.
- The cooling system in your product contains R600a gas. The type of gas used in the product is stated on the type label. This gas is flammable. Therefore, be careful not to damage the cooling system and pipes during use. In case the pipes are damaged;
 1. Do not touch the product or the power cord.
 2. Keep the product away from potential fire sources that could cause it to catch fire.
 3. Ventilate the environment where the product is located. Do not use a fan.
 4. Call Authorized Service.

If the product is damaged and you observe gas escaping, please stay away from the gas. If the gas comes into contact with your skin, it can cause frostbite.

Before throwing away an old and unusable product:

1. Unplug the power plug and unplug it.
2. Cut the power cord and disconnect it from the device together with the plug.
3. To make it difficult for children to get into the appliance, do not remove the shelves and drawers.
4. Remove the doors.
5. Keep the product in a way that it cannot tip over.

6. Do not allow children to play with the worn product.

- Never destroy the product by throwing it into a fire. There is danger of explosion.
 - If there is a lock on the door of the product, the key should be kept out of reach of children.
-

Food Storage Safety

To avoid food spoilage, please pay attention to the following warnings:

- Leaving the doors open for a long time may cause the temperature inside the product to rise.
 - Regularly clean food contact and accessible drain systems.
 - Clean water tanks that have not been used for 48 hours and mains-fed water systems that have not been used for more than 5 days.
 - Store raw meat and fish products in appropriate compartments in the product. Thus, it does not drip or come into contact with other foods.
 - Two-star freezer compartments are used for storing pre-filled foods, making and storing ice and ice cream.
 - One, two and three star compartments are not suitable for freezing fresh food.
 - If the refrigerator product has been left empty for a long time, turn off the product, defrost it, clean it and dry it to protect the body of the product.
-

Maintenance and Cleaning Safety

- Before cleaning or maintaining the refrigerator, unplug it and disconnect the power from the fuse.
 - If you are going to move the product for cleaning purposes, do not pull it by hanging on the door handle. If the handle is pulled too hard, it may cause injury.
 - Do not put your hands, feet and metal objects under or behind the refrigerator. It may cause personal injury due to pinching or any sharp edges.
 - Do not clean by spraying or pouring water on or inside the product. There is a risk of electric shock and fire.
 - When cleaning the product, do not use sharp and abrasive tools or household cleaning products, detergent, gas, gasoline, thinner, alcohol, polish, etc. Do not use substances. Use only cleaning and care products inside the product that are not harmful to food.
 - Never use steam or steam-assisted cleaning materials to clean or defrost the product. Steam may come into contact with live parts of your refrigerator, causing a short circuit or electric shock.
 - Do not use any mechanical tools or other devices other than those recommended by the manufacturer to speed up the defrosting process.
 - Be careful not to allow water to enter the product's ventilation holes, electronic circuits or lighting. Otherwise, there is a risk of fire or electric shock.
 - Use a clean, dry cloth to wipe any foreign matter or dust from the plug terminals. When cleaning the plug, do not use a wet or damp cloth. Otherwise, there is a risk of fire or electric shock.
-

Disposal of the Old Product

Follow the instructions below when disposing of your old product;

- To prevent children from accidentally locking themselves into the product, if the product has a door lock; disable the lock.
 - Coolant splashes can be harmful to the eyes. Do not damage any parts of the cooling system when disposing of the product.
 - The oil in the compressor can be fatal if swallowed or penetrates the respiratory tract.
 - The cooling system in your product contains R600a gas as stated on the type label. This gas is flammable. Never destroy the product by throwing it into a fire. There is danger of explosion!
-

Environmental Instructions

Additional Information

- [↻ Compliance with WEEE Regulation and Disposal of Waste Product](#)
 - [↻ Packaging Information](#)
-

Compliance with WEEE Regulation and Disposal of Waste Product

This product does not contain harmful and prohibited substances specified in the "Regulation on the Control of Waste Electrical and Electronic Equipment" published by the Ministry of Environment and Urbanization of the Republic of Turkey.

DANGER



It complies with the WEEE Regulation. This product is manufactured from high quality parts and materials that are recyclable and reusable. Therefore, do not dispose of the product with household or other waste at the end of its service life. Take it to a collection point for the recycling of electrical and electronic equipment. Ask your local government about these collection points. Help protect the environment and natural resources by recycling used products.

Packaging Information

ANNOUNCEMENT



The packaging of the product is made of recyclable materials in accordance with our National Legislation. Do not dispose of packaging waste together with household or other waste, dispose of it at packaging collection points specified by the local authority.

your refrigerator

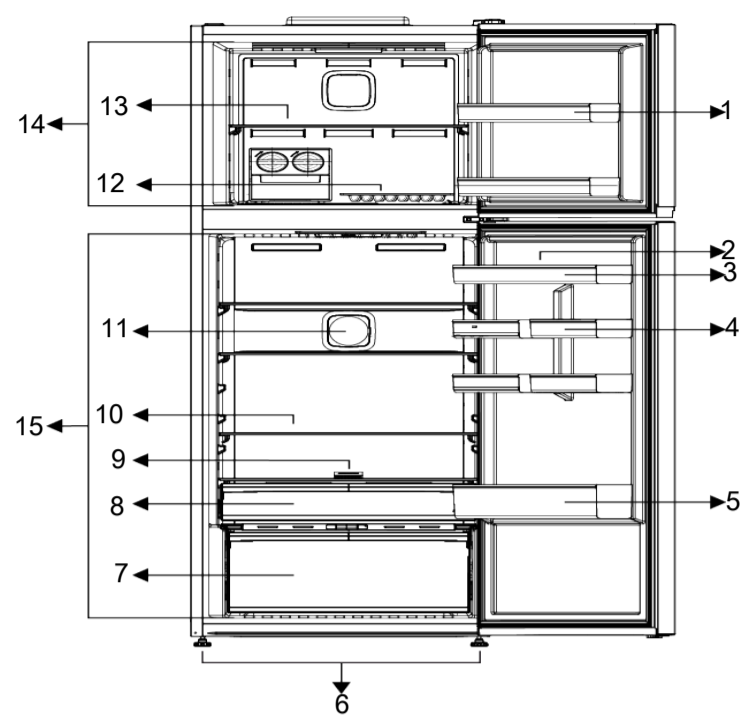

one	Freezer compartment door shelf	2	Ovarian
3	*Refrigerator compartment door shelves	4	* Cooler compartment small door shelves
5	*Bottle rack	6	Adjustable feet
7	Crisper, crisper separator and ethylene filter	8	*Dairy products (cold storage) drawer
9	Filter	10	*Glass shelves
11th	Fan	12	*Ice Box/Ice Makers
13	Freezer compartment glass shelf	14	freezer compartment
15	refrigerator compartment		

***Optional:** The figures in this user manual are schematic and may not be exactly compatible with your product. If the product you purchased does not have the relevant parts, it is valid for other models.

Setup

Right place for installation

ANNOUNCEMENT



Read the “Safety Instructions” section first!

In order for the product to operate efficiently, there must be adequate air circulation around it. If the product is to be placed in a recessed area in the wall, make sure that there is at least 5 cm of space between the ceiling and the side walls. Check that the rear wall spacer (if provided) is in place with the product. If the part is missing, lost or falls, position the product so that there is at least 5 cm of space between the rear surface of the product and the room wall. The space behind is important for the efficient operation of the product.

ANNOUNCEMENT



Do not connect with extension cords or multiple sockets.

ANNOUNCEMENT



The manufacturer is not responsible for any damages that may be caused by operations carried out by unauthorized persons.

WARNING



The product's power plug should not be plugged into the socket during installation. Otherwise there is a risk of death or serious injury!

ANNOUNCEMENT



If the doorway of the room where the product will be placed is too narrow for the product to pass through, remove the door of the room and turn the product sideways; If not, call the authorized service.

- Place the product on a flat surface to avoid shocks.
- Install the product at least 30 cm away from heat sources such as stoves, radiators and stoves, and at least 5 cm away from electric ovens.
- Do not expose the product to direct sunlight and do not keep it in a damp place.

Installing plastic wedges

Plastic wedges included in the product are used to maintain the distance between the product and the wall to ensure air circulation.

- Remove the screws on the product and install the screws provided with the plastic wedges.

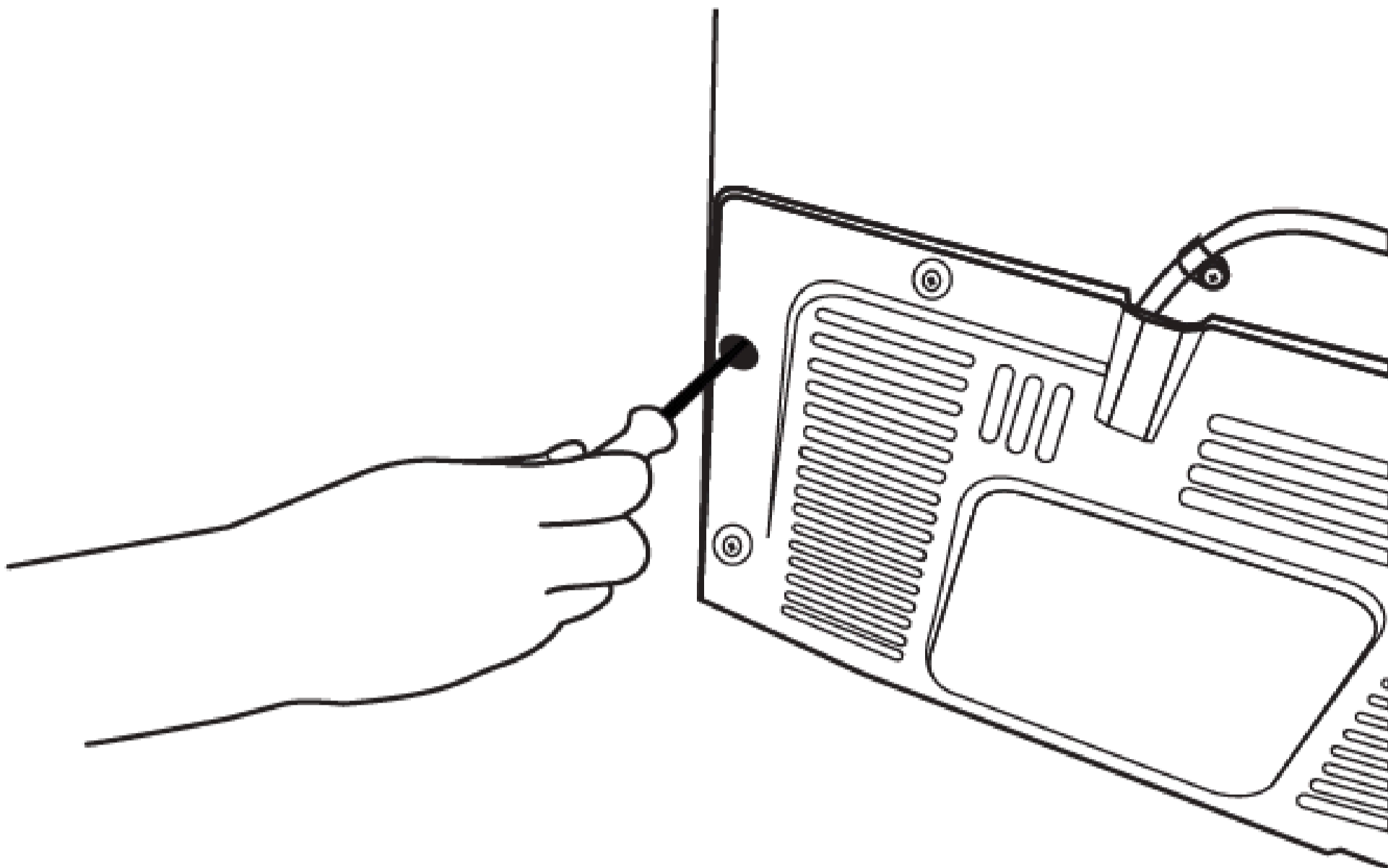

- Attach the 2 plastic wedges to the rear ventilation cover as shown in the figure.

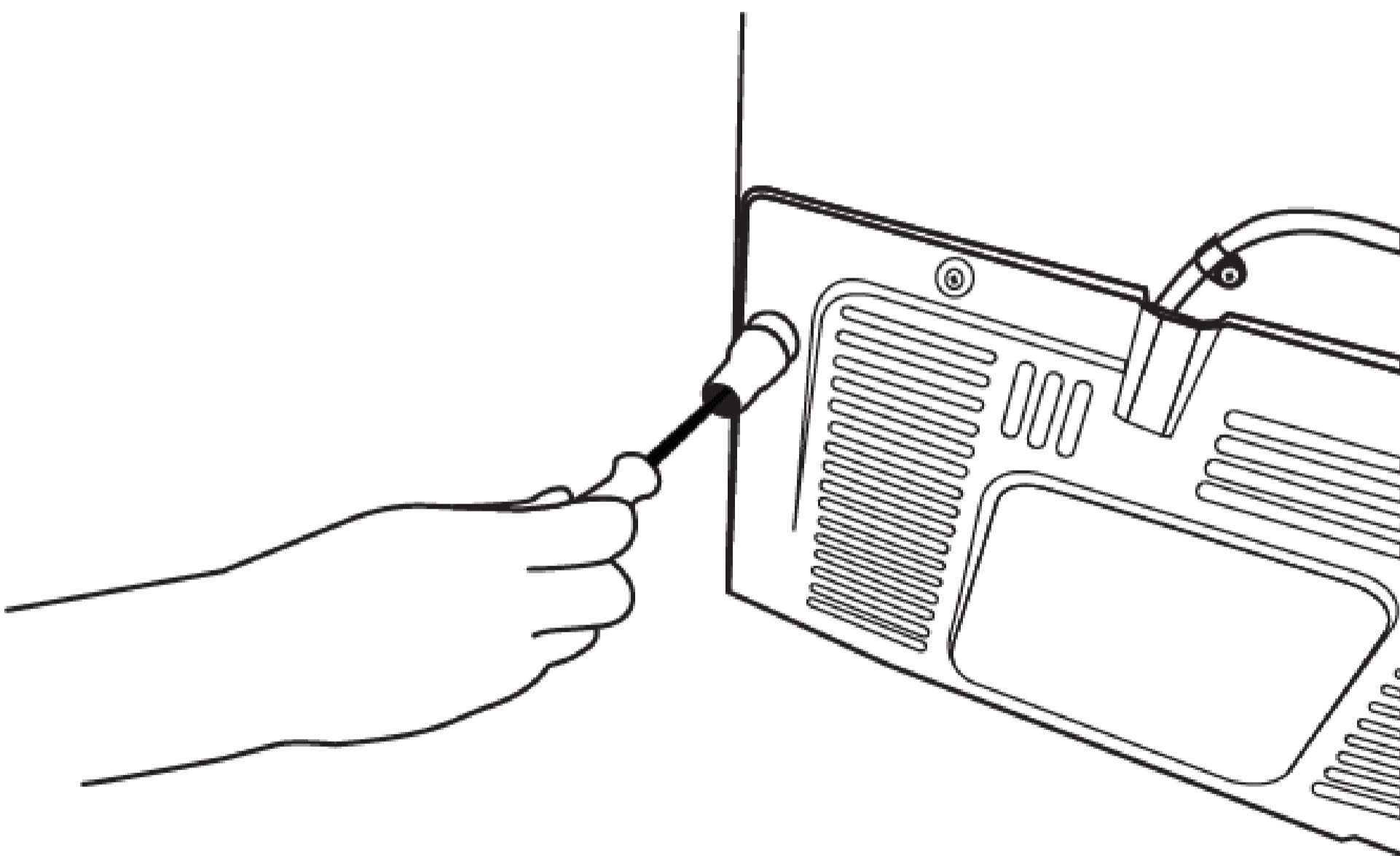

Adjusting the feet

If the product is unstable where you place it, you can adjust the balance of the product by turning the front legs to the right or left.

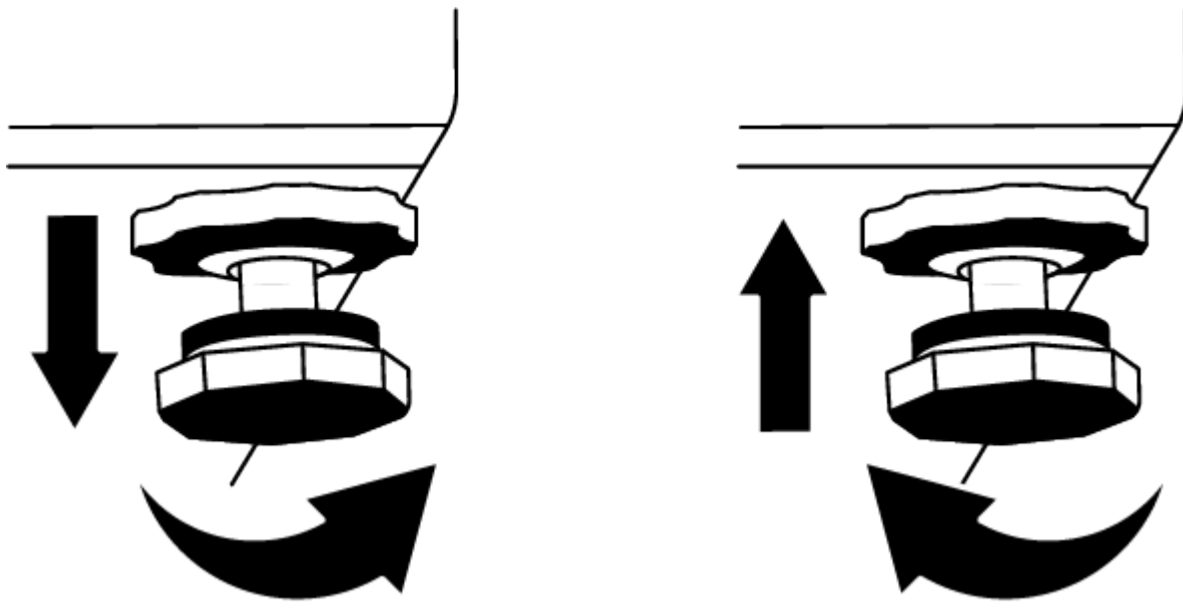

Additional Information

[↗ Electrical connection](#)

Electrical connection

ANNOUNCEMENT



WARNING: Do not connect with extension cords or power strips.

ANNOUNCEMENT



WARNING: Damaged power cable must be replaced by the Authorized Service.

- Our company will not be responsible for any damages that may occur if the product is used without grounding and electrical connection in accordance with national regulations.
- The power cord plug must be easily accessible after installation.

ANNOUNCEMENT



Hot surface warning!

The side walls of your product are equipped with coolant pipes to improve the cooling system. High temperature fluid can flow across these surfaces and cause hot surfaces on the side walls. This is normal and does not require any service. Be careful when touching these areas.

Preliminary

WARNING



Read the “Safety Instructions” section first!

Additional Information

[↪ Things to Do to Save Energy](#)

[↪ First Use](#)

[↪ Climate Class and Its Meanings](#)

Things to Do to Save Energy

WARNING



Connecting the product to electronic energy saving systems is dangerous as it may damage the product.

- This cooling device is not designed to be used as a built-in appliance.
 - Do not keep the doors of your refrigerator open for a long time.
 - Do not put hot food or drinks in your refrigerator.
 - Do not overfill the refrigerator, cooling capacity decreases when the air flow inside is blocked.
 - When the doors of your product are not opened, your product optimizes itself in conditions that will be sufficient to protect your food, since hot and humid air will not enter directly. Under these conditions, the compressor, fan, heater, defrost, lighting, display and other components and functions on the product operate in a way that consumes the least amount of energy according to the needs.
 - If there is more than one option, glass shelves should be placed so that they do not block the air outlets on the back wall, preferably the air outlets are below the glass shelf. This combination can help improve air distribution and energy efficiency.
 - It is highly recommended to use the bottom drawer when loading.
 - Food should be stored using the drawers in the cooling compartment to save energy and protect the food in a better environment.
-

First Use

Before you start using your refrigerator, make sure that preparations are made in accordance with the instructions in the "Safety and Environmental Instructions" and "Installation" sections.

- Let the product run empty for 6 hours without any food and do not open the door unless absolutely necessary.
- It is normal for condensation to occur on the door/body shelves and on the glassware placed inside the product as a result of thermal changes caused by the opening and closing of the product door during use.

ANNOUNCEMENT



You will hear a sound when the compressor starts working. It is normal for the product to make noise even if the compressor is not working, as liquid and gas may be trapped in the cooling system.

ANNOUNCEMENT



It is normal for the front edges of the refrigerator to be warm. These areas are designed to be heated to prevent condensation.

ANNOUNCEMENT



In some models, the instrument panel turns off automatically 1 minute after the door is closed. It will be activated again when the door is opened or any button is pressed.

Climate Class and Its Meanings

Please refer to the Climate Class on the rating plate of your device. Depending on the Climate Class, one of the following information is valid for your device.

- **SN:** Long-Term Temperate Climate: This cooling device is designed for use in ambient temperatures between 10°C and 32°C.
 - **N:** Temperate Climate: This cooling device is designed for use in ambient temperatures between 16°C and 32°C.
 - **ST:** Subtropical Climate: This cooling device is designed for use in ambient temperatures between 16°C and 38°C.
 - **T:** Tropical Climate: This cooling device is designed for use in ambient temperatures between 16°C and 43°C.
-

Control Panel of the product

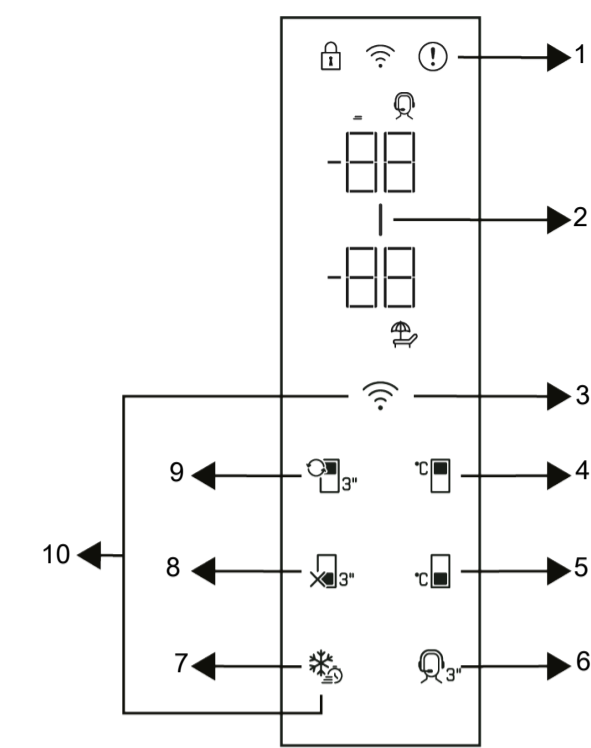

one	Error status indicator	2	Energy saving (display off) indicator
3	*Wireless button	4	Freezer compartment temperature setting button
5	Fridge compartment temperature setting button	6	*Support service button
7	*Quick freezing button / Handle light function setting button	8	*Fridge compartment closing (holiday) function button
9	*Cabin conversion key	10	*Wireless connection settings reset button

ANNOUNCEMENT



Read the “Safety Instructions” section first.

*Optional: The functions shown are optional, the functions on the display panel of your product may differ in terms of shape and location.

Audio and visual functions on the display panel help you use your refrigerator.

1.Error Status Indicator❗

This indicator will be active when the refrigerator cannot cool sufficiently or if any sensor error occurs. The letter "E" will appear on the freezer compartment temperature indicator, and numbers such as 1,2,3.. will appear on the refrigerator compartment temperature indicator. These numbers on the display inform the service about the error that occurred.

When you load hot food into the freezer compartment or leave the door open for a long time, the exclamation mark may light up for a while. This is not a malfunction, this warning will disappear when the food cools down or any button is pressed.

2.Energy Saving (Screen Off) Indicator

When the doors of the product are not opened or closed, energy saving is automatically activated and the energy saving symbol is illuminated. When the energy saving function is activated, all icons on the screen go out except the energy saving icon. If any button is pressed or the door is opened while the energy saving function is active, the energy saving function will exit and the icons on the screen will return to normal. The energy saving function is an active function from the factory and cannot be canceled.

3.*Wireless Button📶

When the button is pressed for a long time (3 seconds), the wireless connection icon on the screen/display flashes slowly (at 0.5 second intervals). This is how the first introduction of the home network to the product begins.

After a wireless connection is established with the product, the wireless connection icon lights up continuously.

After completing the initial setup, the connection can be activated/deactivated by pressing this button. The wireless connection icon blinks quickly (at 0.2 second intervals) until the connection is established. The wireless network icon lights up continuously when the connection is active.

If you cannot connect for a long time, check your connection settings and refer to the 'Troubleshooting' section in the user manual.

HomeWhiz application should be used for wireless connection. Installation steps are explained through the application during installation.

4.Freezer Compartment Temperature Setting Button

Temperature adjustment is made for the freezer compartment. When the button is pressed, the freezer compartment temperature can be adjusted to -15,-16,-18,-19,-20,-22,-24 Celsius.

5.Fridge Compartment Temperature Setting Button

Temperature adjustment is made for the refrigerator compartment. By pressing the button, the refrigerator compartment temperature can be adjusted to 8,7,6,5,4,3,2 and 1 Celsius.

6.*Support Service Button

To activate/deactivate the support service, press this button **for 3 seconds**. Detailed information on the use of the support service is available in the "Support Service Feature" section.

7.*Fast Freezing Button

When the quick freeze button is pressed for **1 second**, the quick freeze icon lights up and the quick freeze function is activated. The freezer compartment temperature is set to -27 Celsius. To cancel the function, the button must be pressed again. The quick freeze function cancels itself automatically. If you want to freeze a large amount of fresh food, press the quick freeze button before putting the food in the freezer compartment.

*Stem Light Function Setting Button

The handle light function can be switched between on and off mode by pressing the fast freezing button for 3 seconds. In off mode, the handle light is activated only when the product door is opened and goes off after a certain period of time after the door is closed. In open mode, the handle light is active when the product door is open, and after a certain period of time after the door is closed, the handle light continues to stay on dimly. The handle light function is factory set to off mode.

8.*Fridge Compartment Closing (Holiday) Function Button

To activate the holiday function, press the button for 3 seconds. The holiday mode is activated and the holiday icon lights up. The refrigerator compartment temperature indicator shows “- -” and the refrigerator compartment does not perform active cooling. When this function is activated, it is not appropriate to keep your food in the refrigerator compartment. The other compartments continue to cool according to their set temperatures. To cancel this function, press the button again for 3 seconds.

9.*Cabin Conversion Key

When the cabin conversion button is pressed for **3 seconds**, the freezer compartment switches between cooler, closed and freezer modes respectively. When it works as a refrigerator compartment, the temperature of the compartment can be adjusted as 8,7,6,5,4,3,2 and 1 Celsius. In off mode, “- -” will be displayed on the cabin temperature display.

10.*Wireless Connection Settings Reset Button ❄️ + 📶

To reset the wireless connection settings, the Quick freeze and Wireless connection buttons must be pressed simultaneously for 3 seconds. When the wireless connection settings are reset/returned to factory settings on the product, all user information that was previously installed will be forgotten.

Using the Product

ANNOUNCEMENT



Read the “Safety Instructions” section first!

Storing food in the freezer compartment

- You can cool faster by activating the Fast Freezing function 4-6 hours before freezing.
- Bring hot meals to room temperature before placing them in the freezer compartment.
- Foods to be frozen should be divided into portions large enough to be consumed each time and frozen in separate packages.
- It is recommended that you pack food before putting it in the freezer.
- To prevent expiration of storage time, write the freezing date, duration and name of the food on the package according to the storage times of different foods.
- Consume the defrosted foods quickly. Defrosted foods cannot be refrozen unless cooked. It is not safe to consume fresh food that has been defrosted and then frozen again without cooking.
- When freezing fresh food, do not let these foods come into contact with already frozen foods. Otherwise, frozen foods will thaw.

Storing frozen food

- Always follow the manufacturer's instructions for how long you should store food. Do not exceed the time specified in these instructions!
- To maintain the quality of food, try to keep the time between purchase and storage as short as possible.
- Buy frozen foods stored at –18°C or lower.
- Ice etc. in its packaging. Avoid taking foods that are This means the product may have partially thawed and then been frozen again. Temperature affects the quality of food.
- Do not exceed the storage time recommended by the food manufacturer. Only take out as much food as you need from the freezer.
- Except when there are extreme conditions in the environment, if your product is set to the set values specified (in the recommended set value table), food will remain fresh for a longer time in both the fresh food compartment and the freezer compartment.
- If the fresh food compartment is set to a lower temperature, fresh fruits and vegetables may become partially frozen.

Recommended set value table

Freezer Compartment Setting	Refrigerator Compartment Setting	Descriptions
-18°C	4°C	This is the normal recommended setting. This setting is used if the ambient temperature is below 30°C; It is recommended.
-20,-22 or -24°C	4°C	These settings are recommended when the ambient temperature exceeds 30°C.
Quick Freeze	4°C	Use it when you want to freeze your food in a short time. When the process is finished, your product will return to its previous position.
-20°C or colder	2°C	If you think that your refrigerator compartment is not cold enough due to the hot environment or frequent opening and closing of the door, use these settings.

fast freezing

1. Activate the fast freezing function 24 hours before loading your fresh foods to freeze.
2. 24 hours after pressing the button, place the food you want to freeze on the first shelf, which has a higher freezing capacity.
3. The fast freezing function will be canceled automatically 52 hours after it is activated.

Deep freezer information

According to IEC 62552 standards, for every 100 liters of freezer compartment volume, the product must be able to freeze 4.5 kg of food at 25°C room temperature in 24 hours at -18°C or lower temperatures.

Long-term preservation of foodstuffs is only possible at -18°C and lower temperatures.

You can preserve the freshness of food items (in the deep freezer at -18°C and lower temperatures) for months.

Food items to be frozen should not come into contact with previously frozen foods to prevent them from partially thawing.

To extend the frozen storage time of vegetables, boil them and drain them. After straining, place in airtight packages and place in the freezer. Bananas, tomatoes, lettuce, celery, boiled eggs, potatoes, etc. Foods are not suitable for freezing. If these foods are frozen, only their nutritional value and eating quality will be negatively affected. There is no deterioration that threatens human health.

Placing food

Freezer compartment shelves : Meat, fish, ice cream, vegetables, etc. different frozen foods such as.

Refrigerator compartment shelves: Foods in pots, closed plates and closed containers, eggs (in closed containers)

Refrigerator compartment door shelves: Small and packaged food or beverages

Crisper: Vegetables and fruits

Fresh food compartment: Delicatessen products (breakfast products, meat products to be consumed in a short time)

Food storage in the refrigerator compartment

- If the compartment door is opened and closed frequently and left open for a long time, compartment temperatures rise significantly, which may reduce the life of the food and cause the food to spoil.
- Food should be stored in closed containers to avoid changes in odor and taste.
- Don't store too much food in your refrigerator. To achieve better and homogeneous cooling, space the food so that cold air can circulate between them.
- Allow air flow by leaving space between the food and the interior wall. If you place food against the back wall, it may freeze.
- Bring hot cooked meals to room temperature before placing them in the refrigerator. Then, you can place the warmed food on the lower shelves of your refrigerator. Do not place warm dishes near perishable foods.
- Defrost your frozen food in the fresh food compartment. In this way, you can cool the fresh food compartment and save energy by using frozen food.
- Storing unripe tropical fruits (mango, melons, papaya, banana, pineapple) in the refrigerator can speed up the ripening process, which means shorter storage time, so it is not recommended.
- You should store onions, garlic, ginger and other root vegetables in dark and cool room conditions, not in the refrigerator.
- If you notice that food has spoiled in the refrigerator, throw that food away and clean the accessories that came into contact with it.
- To quickly cool down dishes cooked in large pots, such as soups and stews, you can divide them into shallow containers and place them in the refrigerator.
- Do not place unpackaged foods near eggs.
- Keep fruits and vegetables separate from each other and store each type together (for example, apples with apples, carrots with carrots).
- Remove the greens from the plastic bag, wrap them in paper towels or a tea towel, and place them in the refrigerator. If you wash such foods before putting them in the refrigerator, do not forget to dry them.
- By storing fruits and vegetables that are prone to drying in perforated or open plastic bags, you can create a humid environment and allow air flow.

- Except when there are extreme conditions in the environment, if your product is set to the set values specified (in the recommended set value table), food will remain fresh for a longer time in both the fresh food compartment and the freezer compartment.

Store different foods in different places according to their characteristics.

food	Location
Egg	Door shelf
Dairy products (butter, cheese)	Zero degree (breakfast) compartment if available
Fruits, vegetables and greens	Fruit and vegetable compartment, crisper or EverFresh+ compartment (if available)
Fresh meat, poultry, fish, sausage derivatives Cooked foods	Zero degree (breakfast) compartment if available
Ready-to-eat foods, packaged products, canned goods and pickles	Top shelves or door shelf
Beverages, bottles, condiments and snacks	Door shelf

Additional Information

- [↻ Changing the Lighting Lamp](#)
- [↻ Door Open Alert](#)
- [↻ Change of Door Opening Direction](#)

Changing the Lighting Lamp

Call the Authorized Service when you need to replace the bulb/LED used for illumination in your refrigerator.

The lamp(s) used in this device cannot be used for lighting purposes at home. The purpose of this lamp is to assist the user in placing refrigerator / freezer foods safely and comfortably.

Door Open Alert

Your refrigerator's door open alarm system may differ depending on the model.

Version 1;

If the door of the product remains open for a certain period of time (between 60 seconds and 120 seconds), an audible warning will be heard, and depending on the product model, a visual warning (lighting flashing) may also be given. When you close the door of the product or press any button on the product screen, if available, the warning sound will stop.

Version 2;

If the door of the product remains open for a certain period of time (between 60 seconds and 120 seconds), a door open warning starts to be given. The door open warning is given gradually. First, an audible warning starts to sound. If the product door is not closed after 4 minutes, a visual warning (light flashing) is activated. If any button on the product screen is pressed, the door open warning will be delayed for a certain period of time (between 60 seconds and 120 seconds). Afterwards, the process will start again. When the product door is closed, the door open warning will be canceled.

Change of Door Opening Direction

The door opening direction of your refrigerator can be changed depending on where you use it. When you need this, be sure to contact your nearest Authorized Service.

Product Features

Additional Information

- [↻ Ice Storage Area](#)
 - [↻ Ovarian](#)
 - [↻ crisper](#)
 - [↻ Humidity Controlled Vegetable Rack](#)
-

Ice Storage Area

Ice Machine

The ice machine allows you to easily get ice from the product.

Using the ice machine

- 1. Remove the water tank from the refrigerator compartment.
- 2. Fill the water tank with water.
- 3. Replace the water tank. The first ice cubes will be ready in the ice maker drawer in the freezer compartment in approximately four hours.

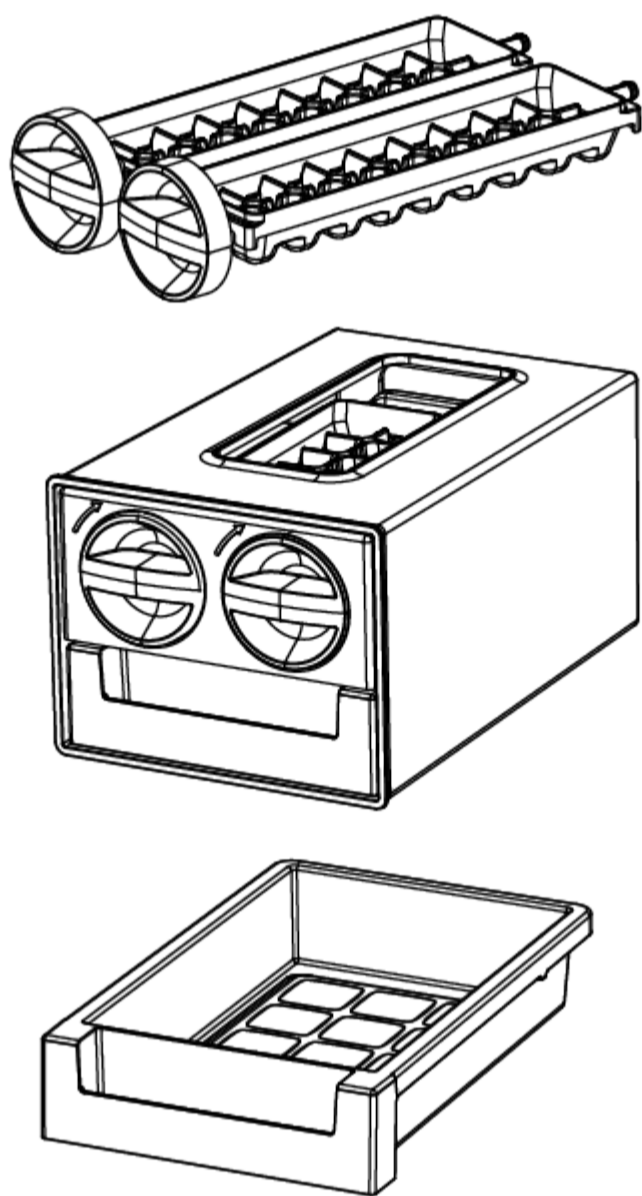

DANGER



Noise may occur when pouring ice. This sound is normal.

ANNOUNCEMENT



Approximately 60-70 cubes of ice can be obtained when the water tank is fully filled.

ANNOUNCEMENT



The water in the water tank should be changed at most every 2-3 weeks.

Ovarian

You can place the egg holder on any door or trunk shelf you want.

If it is to be placed on the body shelf, it is recommended to choose cooler lower shelves.

ANNOUNCEMENT



Never place the egg cup in the freezer compartment.

crisper

The refrigerator crisper is especially designed to keep vegetables fresh without losing their moisture. For this purpose, cold air circulation is intensified throughout the crisper. Store your vegetables and fruits in this compartment. To keep green leafy vegetables for longer periods of time, do not place them side by side with fruits.

Ethylene Filter

The ethylene retaining filter helps remove ethylene gas and bad odors released from vegetables and fruits in the crisper. You can store fruits such as pears, apricots and peaches, which have high ethylene gas production, especially apples, separately with other vegetables and fruits in the same crisper, thanks to the crisper separator.

Ethylene gas released from these fruits may cause your other fruits and vegetables to ripen faster and rot in a shorter time. With this feature, you can keep your fresh food, especially your fresh greens and green vegetables, which are sensitive to ethylene gas, fresher for a longer time.

You can store your food for a longer period of time by placing foods that are sensitive to ethylene gas in one of the crisper separator's two separate compartments, and foods that produce ethylene gas in the other compartment. Foods that produce ethylene gas and are sensitive to ethylene gas are listed below.

Foods that produce ethylene gas; Apple, pear, apricot, peach, nectarine, avocado, kiwi, plum, fig, quince, tomato

Foods sensitive to ethylene gas; Fresh greens (such as lettuce, parsley), strawberries, cherries, grapes, oranges, tangerines, pineapples, cherries, lemons, cucumbers, broccoli, peppers, eggplants, okra, zucchinis

Cleaning the Ethylene Filter

Cleaning of the ethylene filter should be done once a year. Remove the ethylene filter by pulling the filter cover upwards as shown in the figure. Leave the ethylene filter in the sun for a day. During this time, your filter will be cleaned. Put the filter back in place and close the top cover. To ensure maximum effectiveness of the filter and maintain performance, avoid contact with materials such as oil and similar liquids, water and detergent. After such contact, contact the service to replace your filter with a new one.

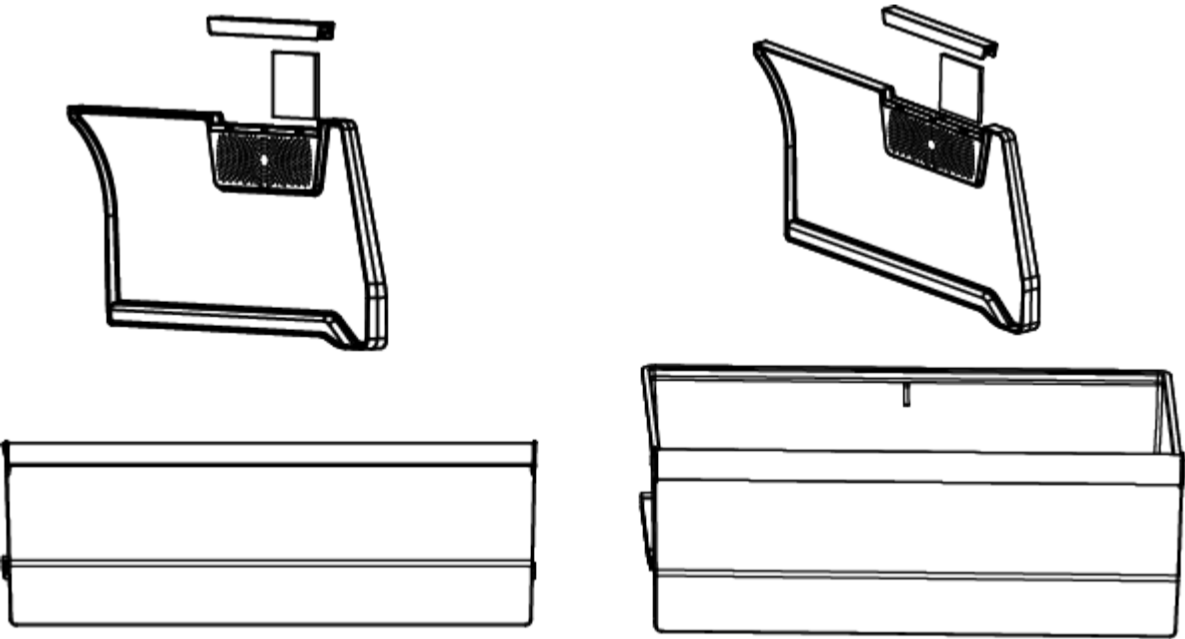

Cleaning the Vegetable Separator

When cleaning the crisper separator, wipe it with a clean and dry cloth at regular intervals to prevent the air holes from being blocked. If the separator is to be washed, be sure to remove the ethylene filter from the separator.

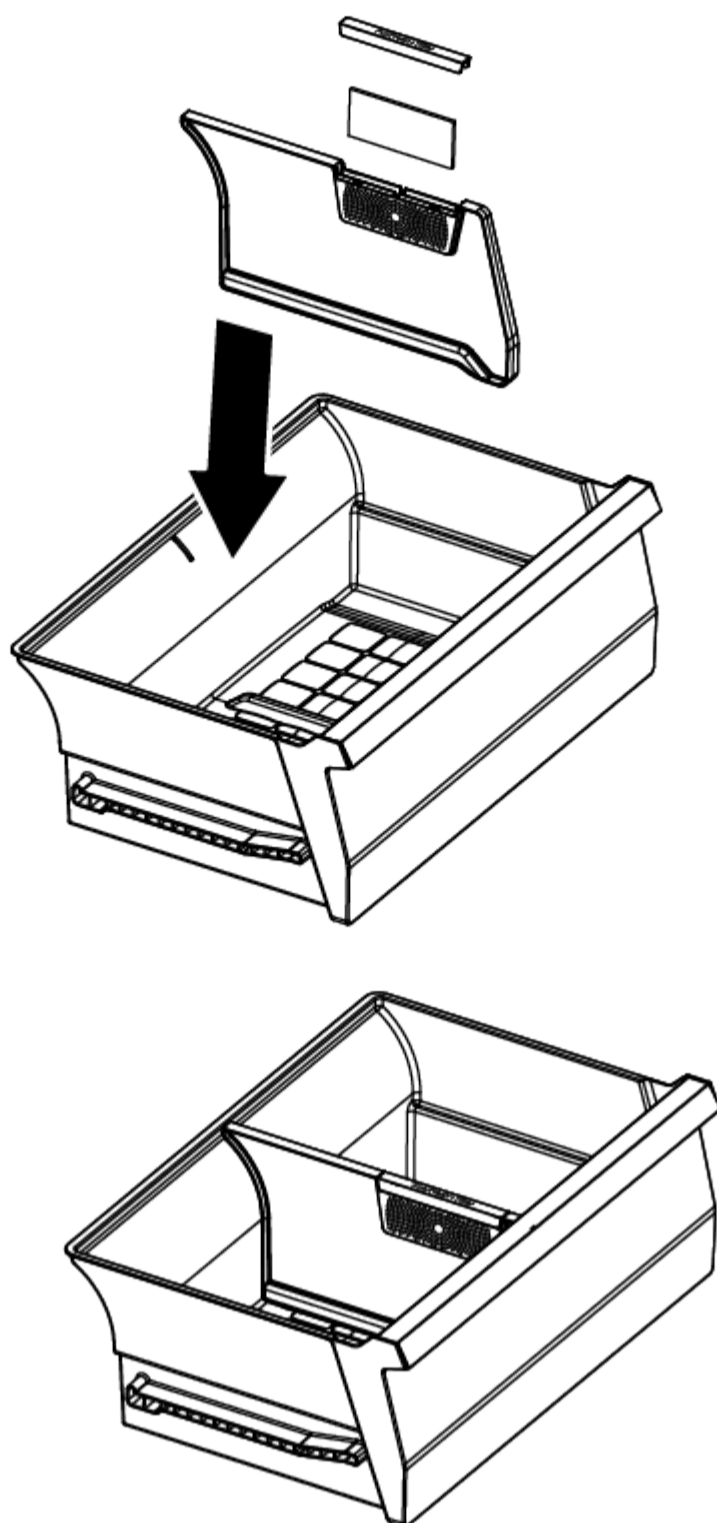

ANNOUNCEMENT



Make sure the holes around the filter are not blocked to allow air circulation.

Humidity Controlled Vegetable Rack

Full fresh+

With the humidity-controlled crisper feature, you can store vegetables and fruits for longer in an environment where ideal humidity conditions are provided.

Thanks to the 3-option humidity adjustment system on the front of the crisper, you can control the humidity inside according to the type of food you store. We recommend that you store your foods by selecting the vegetable option when storing only vegetables, the fruit option when storing only fruit, and the mixed option when storing mixed foods.

In order to see the positive effect of the humidity control system and to increase the storage time of foods, we recommend that you do not store your vegetables and fruits in bags. Leaving vegetables in bags will cause them to rot in a short time. We especially recommend that cucumbers and broccoli not be stored in closed bags. In cases where contact with other vegetables is not preferred for hygiene reasons, a paper bag with a certain porosity, etc. should be used instead of plastic bags. Use packaging materials.

While placing the vegetables, take into account the specific gravity of the vegetables and position the heavy and hard vegetables at the bottom and the light and soft vegetables at the top.

Do not place fruits such as apples, pears, apricots and peaches, which produce high ethylene gas, in the same crisper with other fruits and vegetables. Ethylene gas released from these fruits may cause your other fruits and vegetables to ripen faster and rot in a shorter time.



Maintenance and Cleaning

ANNOUNCEMENT



WARNING:

Read the “Safety Instructions” section first.

ANNOUNCEMENT



WARNING:

Before cleaning your refrigerator, unplug it or disconnect the power from the fuse to which the product is connected.

- Do not use sharp and abrasive tools when cleaning the product. Household cleaning products, soap, detergent, gas, gasoline, thinner, alcohol, polish, etc. Do not use substances.
- The ventilation grille on the back of the product should be dusted (without opening the cover) at least once a year. Clean the product with a dry cloth.
- Be careful not to allow water to enter the lamp housing and other electrical parts.
- Clean the door with a damp cloth. To remove the door and body shelves, remove all contents. Remove the door shelves by lifting them up. After cleaning and drying, replace it by sliding it from top to bottom.
- Never use water or cleaning agents containing chlorine when cleaning the external surface of the product or chrome-plated parts. Chlorine causes rust on such metal surfaces.
- In order to prevent the pressure on the plastic part from being removed and deformed, do not use sharp, abrasive tools, soap, household cleaners, detergent, gas, gasoline, polish, etc. Do not use substances. For cleaning, use a soft cloth with warm water and dry.
- In products without No Frost, water droplets and frost up to one finger thick form on the back wall of the refrigerator compartment. Do not clean, never apply oil or similar substances.
- Use only a slightly damp microfiber cloth to clean the outer surface of the product. Sponges and other types of cleaning cloths may cause scratches.
- To clean the interior of the product, wash all removable parts with a mild solution of soap, water and baking soda. Wash and dry completely. Prevent water from reaching the lights and control panel.

ANNOUNCEMENT



ATTENTION:

Do not use vinegar, rubbing alcohol or other alcohol-based cleaners on any interior surfaces.

Stainless Steel External Surfaces

Use a nonabrasive stainless steel cleaner and apply it with a soft, lint-free cloth. To polish, gently wipe the surface with a microfiber cloth dampened with water and use a dry polishing chamois. Always follow the grain of stainless steel.

Preventing Bad Odors

No substances that will cause odor are used in the production of your product. However, odors may occur due to improper food storage and not cleaning the interior surface of the product properly.

- To prevent this problem, clean it with carbonated water every 15 days.
- Store food in closed containers as microorganisms spread from food stored open will cause bad odor.
- Never store expired or spoiled foods in your refrigerator.

ANNOUNCEMENT



Tea is one of the best known odor receptors. Place the brewed tea pulp into the product in an open container and remove it after 12 hours at the latest. If you keep the tea pulp in the product for more than 12 hours, it may become the source of the odor as it will collect the organisms that cause the odor.

Protection of Plastic Surfaces

If oil is spilled on plastic surfaces, clean it immediately with warm water as the oil may damage the surface.

Troubleshooting

Review this list before calling for service. Doing this will save you from wasting time and money. This list includes common complaints that are not due to faulty workmanship or use of materials. Some features mentioned may not be available in your product.

The refrigerator does not work.

- The plug is not fully seated in the socket. >>> Insert the plug fully into the socket.
- The fuse of the socket to which the product is connected or the main fuse has blown. >>> Check the fuse.

Sweating on the side wall of the refrigerator compartment (MULTI ZONE, COOL CONTROL and FLEXI ZONE).

- The door was opened and closed too frequently. >>> Be careful not to open and close the product door too frequently.
- The environment is very humid. >>> Do not install the product in very humid environments.
- Foods containing liquid may be stored in open containers. >>> Store foods containing liquids in closed containers.
- The door of the product remained open. >>> Do not keep the door of the product open for a long time.
- The thermostat is set too cold. >>> Set the thermostat to the appropriate value.

Compressor is not working.

- In the event of a sudden power outage or unplugging and plugging in, the compressor protective thermic will blow out because the pressure of the gas in the product cooling system has not yet been balanced. The product will start working after approximately 6 minutes. If the product does not start working after this time, call for service.
- It is in the defrosting phase. >>> This is normal for a product that defrosts fully automatically. The defrost cycle occurs periodically.
- The product is not plugged into the socket. >>> Make sure the plug is plugged into the socket.
- Temperature settings are not set correctly. >>> Select the appropriate temperature setting.
- The power has been cut. >>> When power is restored, the product will continue to operate normally.

The operating noise increases while the refrigerator is operating.

- The operating performance of the product may change depending on the change in ambient temperature. This is normal and not a malfunction.

The refrigerator operates too often or for too long.

- The new product may be larger than the old one. Larger products run longer.
- The room temperature may be high. >>> It is normal for it to work longer in hot environments.
- The product may have been recently plugged in or new food may have been added. >>> When the product is newly plugged in or new food is added, it takes longer for the product to reach the set temperature. This situation is normal.
- Large quantities of hot food may have been placed in the product recently. >>> Do not put hot food in the product.
- Doors were opened frequently or remained open for long periods of time. >>> Hot air entering causes the product to work longer. Do not open the doors too often.
- The freezer or refrigerator door may be left ajar. >>> Check if the doors are completely closed.
- The product is set at too low a temperature. >>> Set the temperature of the product to a higher degree and wait for it to reach this temperature.

- The refrigerator or freezer door gasket may be dirty, worn, broken or not properly seated. >>> Clean or replace the gasket. A damaged/broken door seal will cause the product to operate longer to maintain the current temperature.

Freezer temperature is too low but refrigerator temperature is sufficient.

- The freezer compartment temperature is set too low. >>> Set the freezer compartment temperature to a higher degree and check it.

The refrigerator temperature is too low but the freezer temperature is sufficient.

- The refrigerator compartment temperature is set too low. >>> Set the refrigerator compartment temperature to a higher degree and check it.

Food stored in the refrigerator compartment drawers freezes.

- The refrigerator compartment temperature is set too low. >>> Set the refrigerator compartment temperature to a higher value and check it.

The temperature in the refrigerator or freezer is too high.

- The refrigerator compartment temperature may be set too high. >>> The refrigerator compartment temperature setting has an effect on the freezer compartment temperature. Change the temperature of the refrigerator or freezer compartment and wait until the temperature of the relevant compartments reaches a sufficient level.
- Doors were opened frequently or remained open for long periods of time. >>> Do not open the doors too often.
- The door may be ajar. >>> Close the door completely.
- The product may have been recently plugged in or new food may have been added. >>> This is normal. When the product is newly plugged in or new food is added, it takes longer than usual for the product to reach the set temperature.
- Large quantities of hot food may have been placed in the product recently. >>> Do not put hot food in the product.

Shaking or noise.

- The ground is not flat or durable. >>> If the product shakes when moved slowly, balance the product by adjusting its feet. Also make sure that the floor is durable enough to support the product.
- Objects placed on the product may make noise. >>> Remove any items on the product.
- Liquid flowing from the product, spraying, etc. voices are coming.
- Liquid and gas flows occur due to the operating principles of the product. >>> This is normal and not a malfunction.

Wind noise comes from the product.

- A fan is used to perform the cooling process of the product. This is normal and not a malfunction.

Sweating occurs on the inner walls of the product.

- Warm and humid weather increases icing and condensation. This is normal and not a malfunction.
- Doors were opened frequently or remained open for long periods of time. >>> Do not open the doors too often, close them if they are open.
- The door may be ajar. >>> Close the door completely.

Sweating occurs on the outside of the product or between the doors.

- The weather may be humid, this is quite normal in humid weather. >>> Condensation disappears when humidity decreases.

The inside of the product smells bad.

- There was no regular cleaning. >>> Clean the inside of the product regularly with a sponge, warm water or carbonated water.
- Some containers or packaging materials may cause odor. >>> Use odor-free containers or packaging materials.
- Food was placed in the product in open containers. >>> Store food in closed containers. Microorganisms spread from food stored open can cause bad odors.
- Remove expired and spoiled food from the product.

The door does not close.

- Food packages may be preventing the door from closing. >>> Replace the packages blocking the doors.
- The product may not be standing completely upright on the ground. >>> Balance the product by adjusting its feet.
- The ground is not flat or solid. >>> Make sure the ground is flat and strong enough to support the product.

The vegetable bins are stuck.

- Food may be touching the top of the drawer. >>> Organize the food in the drawer.

There is heat on the product surface.

- While your product is operating, high temperatures may be observed between the two doors, on the side panels and in the rear grill area. This is normal and does not require any service.

The fan continues to run when the door is opened.

- The fan may continue to run when the freezer door is opened.

WARNING



WARNING: If you cannot solve the problem despite following the instructions in this section, contact the dealer from whom you purchased the product or the Authorized Service. Do not attempt to repair a malfunctioning product yourself. This is a normal situation.