

Please read this guide first!

Our valued customer,

Please read this manual before using the product.

Thank you for choosing an product. We want your product, which is produced with high quality and technology, to provide youwith the best performance. For this, please read this manual and the other documents provided carefully before using the product.

Take into account all information and warnings specified in the user manual. In this way, you protect yourself and your product against possible dangers.

Keep the user manual. If you give the product to someone else, give the user manual along with it.

The following symbols appear in the user manual and on the product:

ANNOUNCEMENT



Hazard that could result in death or injury.

ANNOUNCEMENT



Risk of electric shock!

WARNING



Important information or useful tips for use.

ATTENTION



Read the user manual.

DANGER



Combustible material, warning of fire hazard.

DANGER



Danger that may result in burns due to contact with hot surfaces.

Safety Instructions

- This section contains safety instructions that will help prevent personal injury or property damage.
- Our company cannot be held responsible for any damages that may occur if these instructions are not followed.

ANNOUNCEMENT



Always have the installation and repair operations done by the manufacturer

ANNOUNCEMENT



Use only original spare parts and accessories.

ANNOUNCEMENT



Do not repair or replace any part of the product unless expressly stated in the user manual.

ANNOUNCEMENT



Do not make technical changes to the product.

Additional Information

- [Purpose of usage](#)
- [Child, Vulnerable Person and Pet Safety.](#)
- [Electrical Safety.](#)
- [Transportation Security.](#)
- [Installation Security.](#)
- [Usage Safety.](#)
- [Food Storage Safety.](#)
- [Maintenance and Cleaning Safety.](#)
- [Disposal of Old Product](#)

Purpose of usage

- This product is not suitable for commercial use and should not be used for purposes other than its intended use.
- This product is designed to be used indoors, at home and similar places.

For example;

In staff kitchens of stores, offices and other work environments,

In farmhouses,

In the environments used by customers of hotels, motels and other accommodation facilities,

In hostel type environments,

In food service and similar non-retail applications.

- The product should not be used on a boat, in a caravan, or in open or closed outdoor spaces such as balconies or terraces.
Exposing the product to rain, snow, sun and wind may create a fire risk.

Child, Vulnerable Person and Pet Safety

- This product can be used by children aged 8 and over and by persons whose physical, sensory or mental capabilities are not fully developed or who lack experience and knowledge, as long as they are supervised or trained about the safe use of the product and its risks.
- Children between the ages of 3 and 8 are allowed to load and unload the refrigerator.
- Electrical products are dangerous to children and pets. Children and pets should not play with, climb on, or climb into the product.
- Children and pets should be kept away from the bottom of the cabin (compressor) area where the electrical parts are located.
- Cleaning and user maintenance should not be carried out by children unless they are supervised.
- Keep packaging materials away from children. There is a risk of injury and suffocation.

Electrical Safety

- The product should not be plugged into the socket during installation, maintenance, cleaning, repair and transportation operations.

If the power cable is damaged, it must be replaced by an authorized service in order to prevent possible dangers.

- Do not pinch the power cord under or behind the product. Do not place a heavy object on the power cord. The power cable should not be excessively bent, crushed or come into contact with any heat source.
- Do not use an extension cord, multiple socket or adapter to operate the product.
- Portable power strips or portable power supplies can overheat and cause fire. For this reason, do not place multiple sockets or portable power sources behind or near the product.
- Do not plug the product into a loose or damaged socket. Such connections may overheat and cause a fire.
- The plug must be in an easily accessible place. If this is not possible, there must be a mechanism (fuse, switch, switch, etc.) on the electrical installation to which the product is connected, that complies with electrical regulations and separates all poles from the network.
- Do not touch the plug with wet hands.
- When unplugging, pull the plug, not the cable.

Transportation Security

- Unplug the product before moving it.
- The product is heavy, do not carry it alone. If the product falls on you, it may cause injuries. Do not hit or drop the product while carrying it.
- When carrying the product, always close its doors and do not hold it by the doors.
- Be careful not to damage the cooling system and pipes during transportation of the product. If the pipes are damaged, do not operate the product

Installation Security

- To make the product ready for use, make sure that the electrical installation and water installation are suitable by looking at the information in the user manual. If the installation is not suitable, call a licensed electrician and plumber and have the necessary arrangements made. Otherwise, electric shock, fire, problems with the product or injury may occur.
- This product is designed for use at altitudes up to 2000 meters above sea level.
- Check if there is any damage on the product before installation. If the product is damaged, do not install it.!
- Be sure to use personal protective equipment (gloves, etc.) when installing, maintaining and repairing the product. Risk of injury!
- Place the product on a clean, flat and hard surface and balance it with the adjustable feet (turning the front feet to the right or left). Otherwise, the refrigerator may topple over and cause injury.
- The place where the product will be installed must be a dry and ventilated place. There should be no carpets, rugs or similar covers under the product. There may be a risk of fire due to insufficient ventilation!
- Do not block the front or top of the ventilation holes. Otherwise, energy consumption will increase and damage to your product may occur.
- When placing the product, make sure that the power cord is not damaged or pinched.
- The product should not be connected to power supply systems such as solar energy power sources. Otherwise, your product may be damaged due to sudden voltage changes!
- The more refrigerant a refrigerator contains, the larger the location it should be installed in. In very small spaces, if there is a gas leak in the cooling system, a flammable gas-air mixture may form. The volume of space required for every 8 grams of refrigerant gas is at least 1 m³. The amount of refrigerant gas in your product is written on the Type Label.
- The place where the product is installed should not be exposed to direct sunlight and should not be exposed to stove, radiator etc. It should not be near a heat source such as If it cannot be avoided to install the product near the heat source, a suitable insulation plate must be used or the minimum distance to the heat source must be as follows:
 - At least 30 cm away from heat sources such as stoves, ovens, heating units and stoves,
 - At least 5 cm away from electric ovens.
- Your product is a protection class type I device.
- Connect the product to a grounded socket that complies with the Voltage, Current and Frequency values specified on the product type label. The socket must have a fuse of 10A – 16A. Our company will not be responsible for any damage that may occur if the product is used without grounding and electrical connection in accordance with local and national regulations.
- The product must not be plugged into a power outlet during installation. Otherwise, there is a risk of electric shock and injury!
- Do not plug the product into sockets that are loose, out of socket, broken, dirty, oily, or at risk of contact with water. These types of connections may cause overheating and fire.
- Place the product power cable and hoses (if any) in a way that does not pose a tripping hazard.
- Moisture and liquid penetration into live parts or the power cord may cause a short circuit. For this reason, do not use the device in damp or splashing areas (e.g. garage, laundry room). If the refrigerator gets wet with water.
- Never connect your refrigerator to electricity saving devices. Such systems are harmful to the product.
- There is a danger of contact with electrical parts when the electronic card cover and compressor rear cover (if included in the product) are removed. Do not disassemble the product's card cover or compressor rear cover (if present on the product). There is a risk of electric shock!

Usage Safety

- Never use chemical solvents on the product. These substances carry the risk of explosion.
 - In case of a malfunction in the product, unplug the product and do not operate it until it is repaired by the authorized service. There is a risk of electric shock!
 - Do not place flame sources (e.g. candles, cigarettes) on or near the product.
 - Do not climb onto the product. Risk of falling and injury!
 - Do not damage the cooling system pipes using cutting or piercing tools. If gas pipes, pipe extensions or surface coatings are punctured, the refrigerant that will spray out will cause skin irritation and eye injuries.
 - Do not place or use electrical appliances in the refrigerator/freezer unless recommended by the manufacturer.
 - Be careful not to get your hands or any part of your body caught in the moving parts inside the product. Be careful not to get your fingers caught between the door and the cabinet. Be careful when opening and closing the door if there are children around.
 - Never put ice creams, ice cubes and frozen foods into your mouth immediately after taking them out of the freezer. There is a risk of frostbite!
 - Do not touch the inside walls of the freezer, metal parts or products stored in the freezer with wet hands. There is a risk of freezer burn!
 - Do not place cans and bottles containing carbonated drinks or liquids that can freeze in the freezer compartment. The cans or bottles may explode. There is a risk of injury and material damage!
 - Do not use or place temperature-sensitive substances such as flammable sprays, flammable objects, dry ice or other chemicals near the refrigerator. There is a risk of burning and explosion!
 - Do not store explosive materials, such as aerosol cans containing flammable materials, inside your product.
 - Do not place containers containing liquids uncovered on the product. Splashing water on an electrical part may cause electric shock or fire hazard.
 - This product is not suitable for the storage and cooling of medicines, blood plasma, laboratory preparations or similar substances and products subject to the Medical Product Directive.
 - If the product is used for purposes other than its intended purpose, it may cause damage or deterioration of the products stored inside.
 - If your refrigerator has Blue light, do not look at this light with optical instruments. Do not look directly at the UV LED lamp for a long time. Ultraviolet rays can cause eye strain.
 - Do not fill the product beyond its capacity. Injuries or damage may occur as a result of the contents of the refrigerator falling out when the door is opened. Similar problems may also occur when any object is placed on the product.
 - Be sure to clear away any ice or water that may have fallen onto the floor to avoid injury.
 - Replace the shelves/bottle shelves on the door of your refrigerator only when the shelves are empty. There is a risk of injury!
 - Do not place anything that might fall/overturn on the product. When opening and closing the door, items may fall and cause injury and/or property damage.
 - Do not strike or apply excessive force to glass surfaces. Breaking the glass may result in personal injury and/or property damage.
 - The cooling system in your product contains R600a gas. The type of gas used in the product is specified on the type label. This gas is flammable. Therefore, be careful not to damage the cooling system and pipes during use. In case of damage to the pipes;
1. Do not touch the product or the power cord.
 2. Keep the product away from potential fire sources that could cause it to catch fire.
 3. Ventilate the environment where the product is located. Do not use a fan.

If the product is damaged and you observe gas escaping, please stay away from the gas. If the gas comes into contact with your skin, it may cause frostbite.

Before throwing away an old and unusable product:

1. Pull out the power plug and remove it from the socket.
2. Cut the power cord and remove it from the device along with the plug.
3. To make it difficult for children to get inside the appliance, do not remove the shelves and drawers.
4. Remove the doors.

5. Store the product so that it does not tip over.

6. Do not allow children to play with the worn product.

- Never dispose of the product by throwing it into fire. There is a risk of explosion.
- If there is a lock on the door of the product, the key should be kept in a place out of reach of children.

Food Storage Safety

To avoid food spoilage, please pay attention to the following warnings:

- Keeping the doors open for a long time may cause the temperature inside the product to rise.
- Clean food contact and accessible drain systems regularly.
- Clean water tanks that have not been used for 48 hours and mains-fed water systems that have not been used for more than 5 days.
- Store raw meat and fish products in appropriate compartments in the product. Thus, it does not drip or come into contact with other foods.
- Two-star freezer compartments are used for storing pre-filled foods, making and storing ice and ice cream.
- One, two and three star compartments are not suitable for freezing fresh food.
- If the refrigerator has been left empty for a long time, turn it off, defrost it, clean and dry the product to protect the body of the product.

Maintenance and Cleaning Safety

- Before cleaning or maintaining the refrigerator, unplug it and disconnect the power from the fuse.
- If you are going to move the product for cleaning purposes, do not pull by hanging on the door handle. If the handle is pulled too hard, it may cause injury.
- Do not put your hands, feet or metal objects under or behind the refrigerator. It may cause personal injury due to pinching or any sharp edges.
- Do not clean the product by spraying or pouring water onto or into it. There is a risk of electric shock and fire.
- When cleaning the product, do not use sharp and abrasive tools or household cleaning products, detergents, gas, gasoline, thinner, alcohol, polish, etc. Use only cleaning and maintenance products that are not harmful to foodstuffs inside the product.
- Never use steam or steam-assisted cleaning materials to clean or defrost the product. Steam may come into contact with electrically live areas of your refrigerator, causing a short circuit or electric shock.
- Do not use any mechanical tools or other devices other than those recommended by the manufacturer to speed up the defrosting process.
- Be careful not to let water get into the product's ventilation holes, electronic circuits or lighting. Otherwise, there is a risk of fire or electric shock.
- Use a clean, dry cloth to wipe off any foreign matter or dust on the plug pins. Do not use a wet or damp cloth when cleaning the plug. Otherwise, there is a risk of fire or electric shock.

Disposal of Old Product

Follow the instructions below when disposing of your old product;

- To prevent children from accidentally locking themselves into the product, if the product has a door lock; disable the lock.
- Coolant splashes can be harmful to the eyes. Do not damage any parts of the cooling system when disposing of the product.
- The oil in the compressor can be fatal if swallowed or penetrates the respiratory tract.
- The cooling system in your product contains R600a gas as stated on the type label. This gas is flammable. Never destroy the product by throwing it into a fire. There is danger of explosion!

Environmental Instructions

Additional Information

[Compliance with WEEE Regulation and Disposal of Waste Product](#)

[Packaging Information](#)

Compliance with WEEE Regulation and Disposal of Waste Product

This product does not contain harmful and prohibited substances specified in the "Regulation on the Control of Waste Electrical and Electronic Equipment" published by the Ministry of Environment and Urbanization of the Republic of Turkey.

DANGER

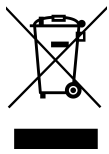

It complies with the WEEE Regulation. This product is manufactured from high quality parts and materials that are recyclable and reusable. Therefore, do not dispose of the product with household or other waste at the end of its service life. Take it to a collection point for the recycling of electrical and electronic equipment. Ask your local government about these collection points. Help protect the environment and natural resources by recycling used products.

Your fridge

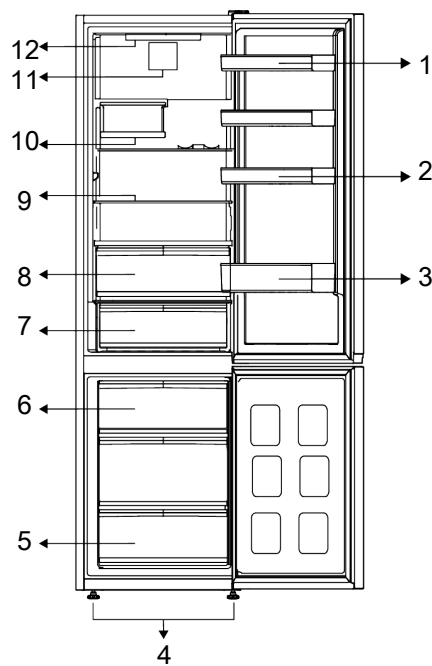

one	* Adjustable Door Shelves	2	* Ovaries
3	* Bottle Rack	4	* Adjustable Front Feet
5	* Freezer Compartment	6	* Ice Tray
7	* Cold Storage Drawer	8	* Crisper
9	* Adjustable Shelves	10	* Foldable Wine Rack
11th	* Fan	12	* Lighting Lamp

***Optional:** The figures in this user manual are schematic and may not be exactly compatible with your product. If the relevant parts are not included in the product you purchased, they are valid for other models.

Setup

WARNING



Read the “Safety Instructions” section first!

Additional Information

[Right Place for Installation](#)

[Electrical connection](#)

[Adjusting the Feet](#)

[Hot Surface Warning](#)

Right Place for Installation

To make the product ready for use, make sure that the electrical installation and water installation are appropriate by looking at the information in the user manual. If not, call a licensed electrician and plumber and have the necessary arrangements made.

WARNING



WARNING:

The manufacturer is not responsible for any damage that may be caused by operations carried out by unauthorized persons.

WARNING



WARNING:

The product's power plug should not be plugged into the socket during installation. Otherwise there is a risk of death or serious injury!

WARNING



WARNING:

If the doorway of the room where the product will be placed is too narrow for the product to pass through, remove the door of the room and turn the product sideways to pass through; if this does not work.

- Place the product on a flat surface to avoid shocks.
- Install the product at least 30 cm away from heat sources such as stoves, radiators and stoves, and at least 5 cm away from electric ovens.
- Do not expose the product to direct sunlight and do not keep it in a humid place.
- In order for the product to work efficiently, there must be proper air circulation around it. If you are going to place the product in a recessed place in the wall, make sure there is at least 5 cm of space between it and the ceiling and side walls.
- Check that the rear wall spacer (if supplied) is in place.
- If the part is missing, lost or dropped, position the product so that there is at least 5 cm of space between the rear surface of the product and the room wall. The space behind is important for the efficient operation of the product.

Electrical connection

WARNING



Do not connect using extension cords or multiple sockets.

WARNING



Damaged power cable must be replaced by the Authorized Service.

ANNOUNCEMENT



If two coolers are placed side by side, there should be at least 4 cm of space between them.

- Our company will not be responsible for any damages that may occur if the product is used without grounding and electrical connection in accordance with national regulations.
- The plug of the power cable must be easily accessible after installation.
- Do not use an extension cord or wireless multiple group socket between your refrigerator and the wall socket.

Adjusting the Feet

If the product is unstable where you place it, adjust it by turning the front adjustment feet to the right or left.

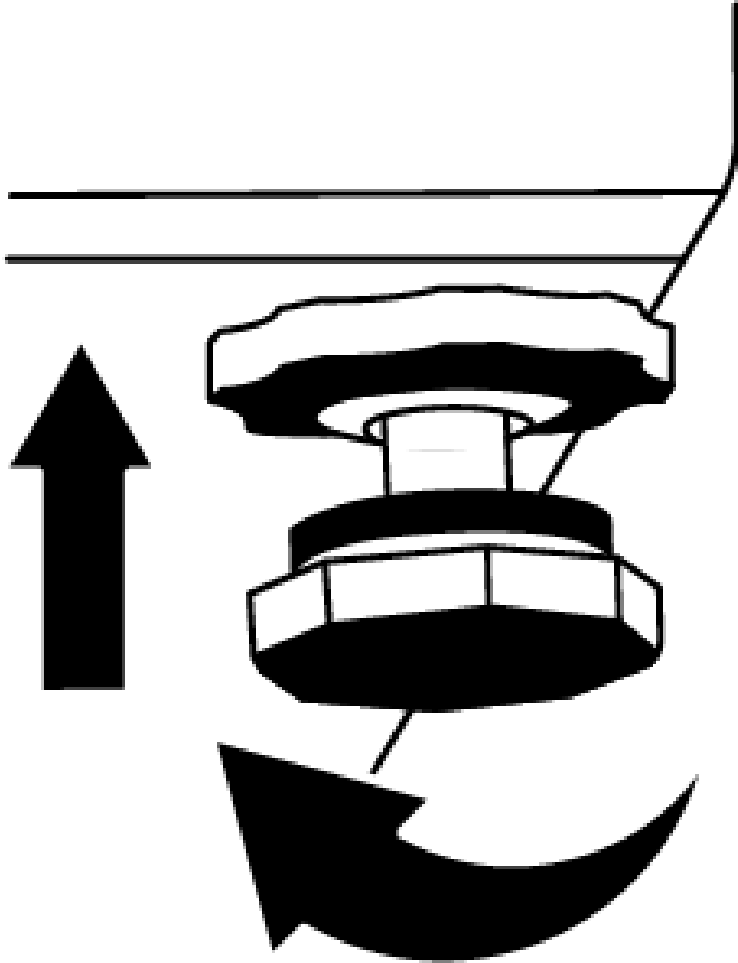
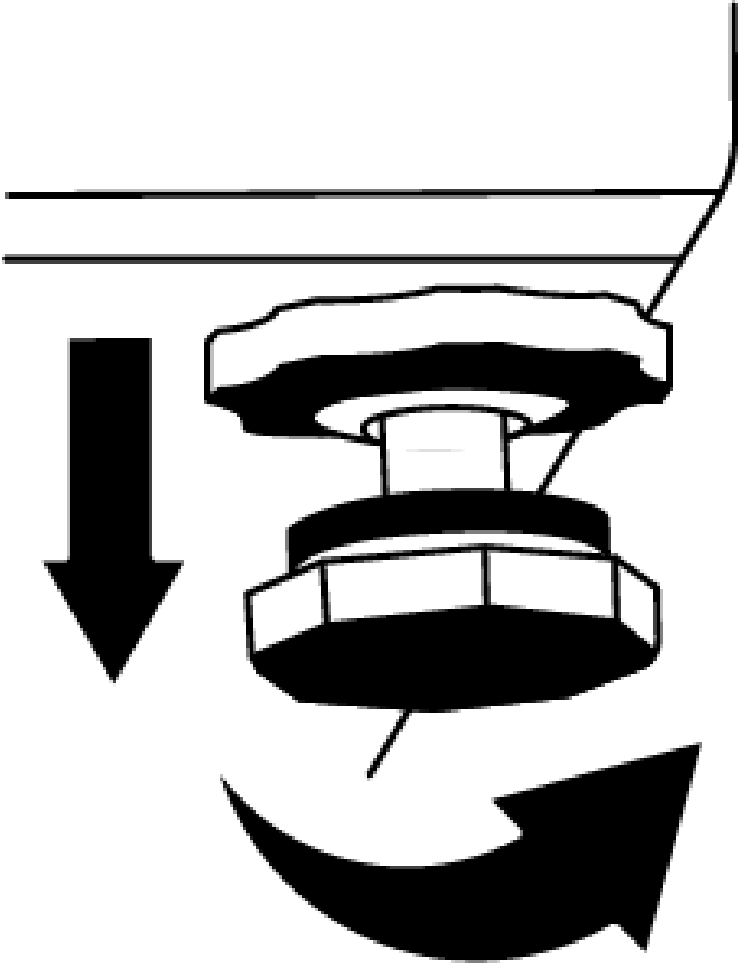

Hot Surface Warning

The side walls of your product are equipped with coolant pipes to improve the cooling system. High temperature fluid can flow across these surfaces and cause hot surfaces on the side walls. This is normal and does not require any service. Be careful when touching these areas.

Preliminary

WARNING



Read the “Safety Instructions” section first!

Additional Information

[What to Do to Save Energy.](#)

[First Use](#)

[Climate Class and Meanings](#)

What to Do to Save Energy

WARNING



Connecting the product to electronic energy saving systems is dangerous as it may damage the product.

- This cooling appliance is not designed to be used as a built-in appliance.
- Do not keep your refrigerator doors open for long periods of time.
- Do not put hot food or drinks in your refrigerator.
- Do not overfill the refrigerator, cooling capacity will decrease when airflow inside is blocked.
- Since hot and humid air will not enter directly when the doors of your product are not opened, your product optimizes itself under conditions sufficient to protect your food. Under these conditions, the compressor, fan, heater, defrost, lighting, indicator and other components and functions on the product operate in a way that consumes the least energy according to needs.
- In case of multiple options, glass shelves should be positioned so that they do not block the air outlets on the rear wall, preferably with the air outlets under the glass shelf. This combination can help improve air distribution and energy efficiency.
- It is highly recommended to use the bottom drawer when loading.
- Depending on the features of your product, thawing frozen food in the refrigerator compartment will both save energy and preserve the quality of the food.
- To load the most food into the freezer compartment of your refrigerator, the upper drawers should be removed and loaded onto wire/glass shelves.
- Food should be stored using the drawers in the cooling compartment to save energy and protect the food in a better environment.
- Direct contact between the temperature sensor located in the freezer compartment and food packages should be prevented.

First Use

Before you start using your refrigerator, make sure that preparations are made in accordance with the instructions in the "Safety and Environmental Instructions" and "Installation" sections.

- Let the product run empty for 6 hours without any food and do not open the door unless absolutely necessary.
- It is normal for condensation to occur on the door/body shelves and on the glassware placed inside the product as a result of thermal changes caused by the opening and closing of the product door during use.

ANNOUNCEMENT



You will hear a sound when the compressor starts working. It is normal for the product to make noise even if the compressor is not working, as liquid and gas may be trapped in the cooling system.

ANNOUNCEMENT



It is normal for the front edges of the refrigerator to be warm. These areas are designed to get warm to prevent condensation.

ANNOUNCEMENT



In some models, the instrument panel turns off automatically 1 minute after the door is closed. It will be activated again when the door is opened or any button is pressed.

Climate Class and Meanings

Please refer to the Climate Class on the rating plate of your device. Depending on the Climate Class, one of the following information is valid for your device.

- **SN:** Long-Term Temperate Climate: This cooling device is designed for use in ambient temperatures between 10°C and 32°C.
- **N:** Temperate Climate: This refrigerator is designed for use in ambient temperatures between 16°C and 32°C.
- **ST:** Subtropical Climate: This cooling device is designed for use in ambient temperatures between 16°C and 38°C.
- **T:** Tropical Climate: This cooling device is designed for use in ambient temperatures between 16°C and 43°C.

Operating the Product

ANNOUNCEMENT



Read the “Safety Instructions” section first!

- Do not use any mechanical tools or other devices other than those recommended by the manufacturer to speed up the defrosting process.
- Never use parts such as doors and drawers on your refrigerator as support or steps. This may cause the product to tip over or damage its parts.
- The product should only be used for food storage.
- If you will be away from home for a long time (for example, on vacation) and will not use the Icemaker or water dispenser, turn off the water valve. Otherwise, water leakage may occur.

Turning off the product

- If you are not going to use the product for a long time, unplug the product.
- Remove foods to prevent odor,
- Wait for the ice to melt, clean the interior and let it dry, leave the doors open to prevent damage to the interior body plastics.

Using Your Product

Additional Information

[Control Panel of the product](#)

[Vegetable Basket](#)

[Door Open Warning](#)

[Folding Shelf](#)

[Changing the Lighting Lamp](#)

[AeroFresh](#)

Control Panel of the product

The operating temperature is adjusted by the temperature control.

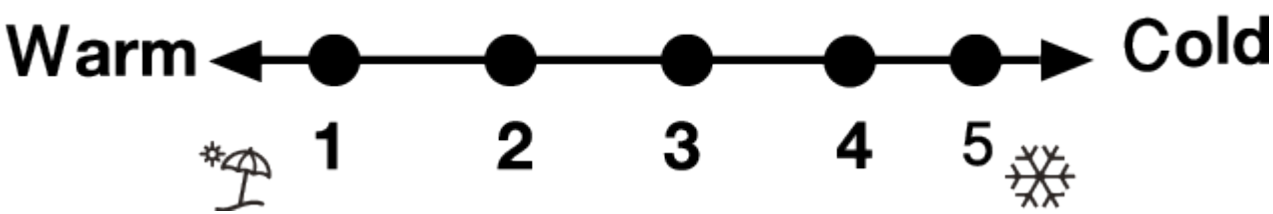
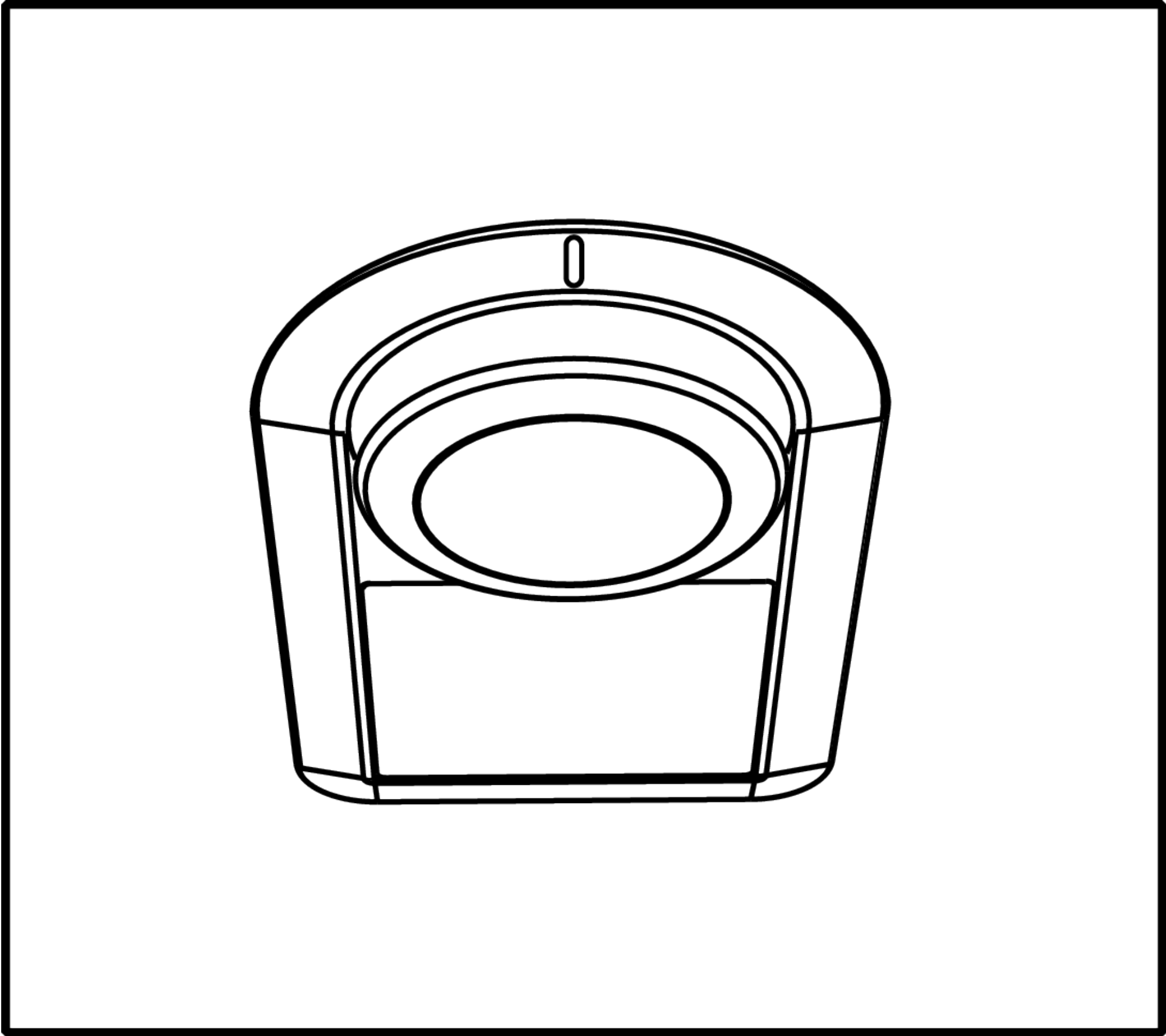

1=Lowest cooling setting (Warmest setting)

4=Highest cooling setting (Coolest setting)

The average temperature inside the refrigerator compartment should be around +5°C.

Please select a setting according to the desired temperature.

Please note that there will be different temperatures in the cooling area.

Remember.The coldest zone is just above the vegetable compartment.

The internal temperature also depends on the ambient temperature, how often the door is opened, and the amount of food stored inside the refrigerator.

Frequent opening of the lid causes the internal temperature to rise.

Therefore, it is recommended that you close the lid as soon as possible after opening it for any reason.

Vegetable Basket

The refrigerator crisper is especially designed to keep vegetables fresh without losing their moisture. For this purpose, cold air circulation is intensified throughout the crisper. Store your vegetables and fruits in this compartment. To preserve green leafy vegetables for longer periods, do not place them side by side with fruits.

Door Open Warning

Your refrigerator's door open alarm system may differ depending on the model.

Version 1;

If the product door remains open for a certain period of time (between 60 and 120 seconds), an audible warning will be heard, and depending on the product model, a visual warning (flashing lighting) may also be given. The warning sound will stop when you close the product door or press any button on the product screen, if any.

Version 2;

If the product door remains open for a certain period of time (between 60 and 120 seconds), the door open warning will be given. The door open warning will be given gradually. First, an audible warning will be given. If the product door is still not closed after 4 minutes, a visual warning (flashing lighting) will be activated. If any button is pressed on the product screen, the door open warning will be postponed for a certain period of time (between 60 and 120 seconds). Then, the process will start again. When the product door is closed, the door open warning will be canceled.

Folding Shelf

It allows the user to store bottles when needed. To use the shelf section, hold the plastic part and gently pull it downwards. You can now use the folding shelf.

ANNOUNCEMENT



It is recommended to store a maximum of 2 bottles on the folding shelf.

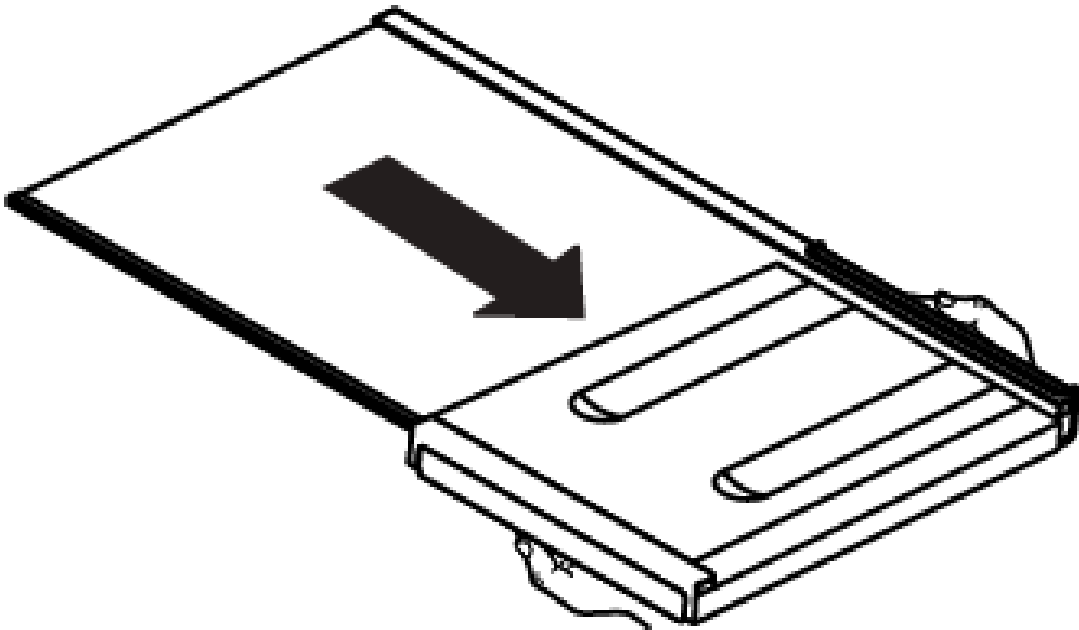
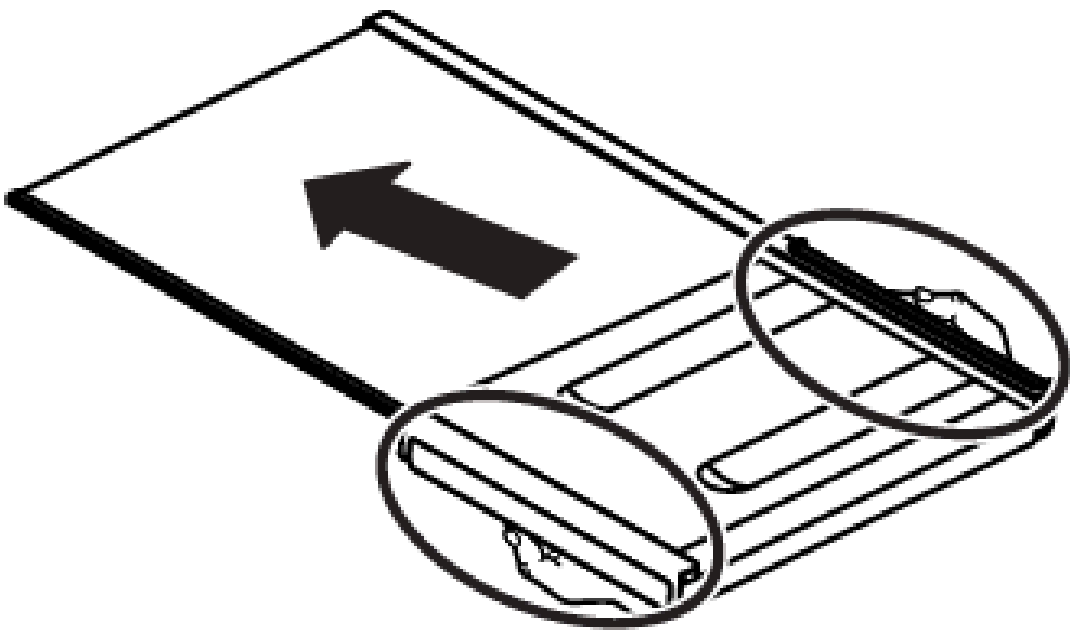
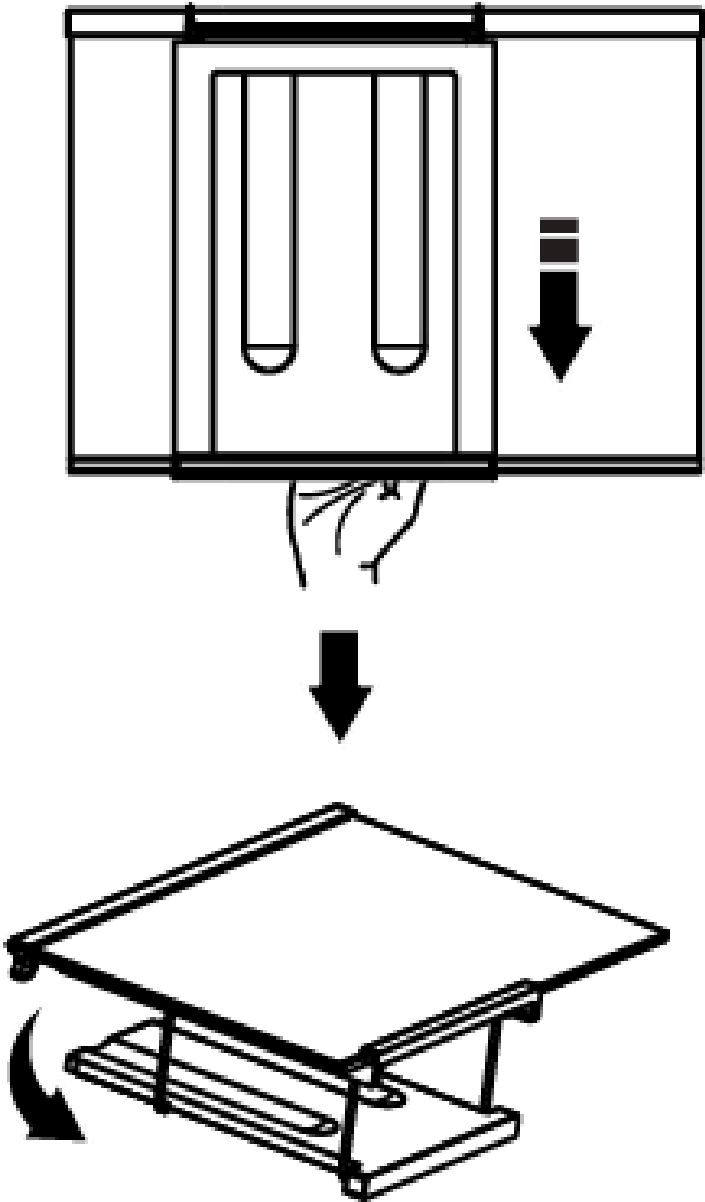

To group the folding shelf, first remove the glass shelf from the refrigerator. Place the plastic part on the glass shelf by pushing it from the front and back channels shown in the picture. The product will be ready for use with the folding shelf.

To remove the folding shelf, first remove the glass shelf from the refrigerator. Then, hold the plastic part and pull it in any direction. You can now use the product without the folding shelf if necessary.

Changing the Lighting Lamp

When the Bulb/LED used for illumination in your refrigerator needs to be replaced.

The lamp(s) used in this device cannot be used for lighting purposes at home. The purpose of this lamp is to assist the user in placing refrigerator / freezer foods safely and comfortably.

AeroFresh

It is an air distribution system that provides homogeneous temperature distribution. Thanks to this air circulation, homogeneous temperature distribution is achieved within the fresh food storage compartment, while temperature fluctuations are kept at low levels. Air is not blown directly onto the food and helps reduce moisture loss. It preserves the freshness of foods stored in the fresh food compartment of the refrigerator. In this way, your food is stored at more stable temperatures and its contact with air is reduced. Foods are prevented from losing moisture and drying and shrinking, ensuring freshness for a longer period of time.

Maintenance and Cleaning

ANNOUNCEMENT



WARNING:

Read the “Safety Instructions” section first.

ANNOUNCEMENT



WARNING:

Before cleaning your refrigerator, unplug it or cut off the power from the fuse to which the product is connected.

- Do not use sharp and abrasive tools when cleaning the product. Household cleaning products, soap, detergent, gas, gasoline, thinner, alcohol, polish, etc. Do not use substances.
- The ventilation grill on the back of the product should be dusted (without opening the cover) at least once a year. Clean the product with a dry cloth.
- Be careful not to let water enter the lamp housing or other electrical parts.
- Clean the door with a damp cloth. To remove the door and body shelves, remove all the contents. Remove the door shelves by lifting them upwards. After cleaning and drying, replace them by sliding them from top to bottom.
- Never use water or cleaning agents containing chlorine when cleaning the external surface of the product or chrome-plated parts. Chlorine causes rust on such metal surfaces.
- To prevent the prints on the plastic part from being removed or deformed, do not use sharp, abrasive tools, soap, household cleaners, detergents, gas, gasoline, polish, etc. Use warm water and a soft cloth for cleaning and dry.
- In products without No Frost, water droplets and frost up to one finger thick form on the back wall of the refrigerator compartment. Do not clean, never apply oil or similar substances.
- When cleaning the outer surface of the product, use only a slightly damp microfiber cloth. Sponges and other types of cleaning cloths may cause scratches.
- To clean the interior surfaces of the product, wash all removable parts with a mild solution of soap, water and baking soda. Wash and dry completely. Avoid getting water on the lights and control panel.

ANNOUNCEMENT



ATTENTION:

Do not use vinegar, rubbing alcohol or other alcohol-based cleaners on any interior surfaces.

Stainless Steel Exterior Surfaces

Use a non-abrasive stainless steel cleaner and apply with a soft, lint-free cloth. To polish, gently wipe the surface with a microfiber cloth dampened with water and use a dry polishing chamois. Always follow the grain of the stainless steel.

Preventing Bad Odors

No substances that will cause odor are used in the production of your product. However, odors may occur due to improper food storage and not cleaning the interior surface of the product properly.

- To prevent this problem, clean it with baking soda water every 15 days.
- Store food in closed containers as microorganisms spread from food stored open will cause bad odor.
- Never store expired or spoiled foods in your refrigerator.

ANNOUNCEMENT



Tea is one of the best known odor receptors. Place the brewed tea pulp into the product in an open container and remove it after 12 hours at the latest. If you keep the tea pulp in the product for more than 12 hours, it may become the source of the odor as it will collect the organisms that cause the odor.

Protection of Plastic Surfaces

If oil is spilled on plastic surfaces, clean it immediately with warm water as the oil may damage the surface.

Troubleshooting

The refrigerator does not work.

- The plug is not fully seated in the socket. >>> Insert the plug into the socket until it fits fully.
- The fuse of the socket to which the product is connected or the main fuse has blown. >>> Check the fuse.

Condensation on the side wall of the refrigerator compartment (MULTI ZONE, COOL CONTROL and FLEXI ZONE).

- The door was opened and closed too frequently. >>> Be careful not to open and close the door of the product too frequently.
- The environment is very humid. >>> Do not install the product in very humid environments.
- Foods containing liquid may be stored in open containers. >>> Store foods containing liquids in closed containers.
- The door of the product remained open. >>> Do not keep the door of the product open for a long time.
- The thermostat is set too cold. >>> Set the thermostat to the appropriate value.

Compressor not working.

- In case of sudden power outage or plug-in and plug-out, the compressor protective thermal trips because the gas pressure in the product cooling system has not yet been balanced. The product will start operating after approximately 6 minutes. If the product does not start operating after this period.
- It is in the defrosting cycle. >>> This is normal for a product that defrosts fully automatically. The defrost cycle occurs periodically.
- The product is not plugged into the socket. >>> Make sure the plug is plugged into the socket.
- Temperature settings are not set correctly. >>> Select appropriate temperature setting.
- Power has been cut off. >>> When power returns, the product will continue to operate normally.

The operating noise increases while the refrigerator is operating.

- The operating performance of the product may change depending on the change in ambient temperature. This is normal and not a malfunction.

The refrigerator runs too often or for too long.

- The new product may be larger than the old one. Larger products run longer.
- The room temperature may be high. >>> It is normal for it to work longer in hot environments.
- The product may have been plugged in recently or new food may have been added. >>> When the product is plugged in recently or new food is added, it takes longer for the product to reach the set temperature. This is normal.
- Large amounts of hot food may have been placed in the product recently. >>> Do not place hot food in the product.
- The doors have been opened frequently or have been left open for a long time. >>> The warm air entering the product causes it to operate for a longer period of time. Do not open the doors too frequently.
- The freezer or refrigerator door may be ajar. >>> Check if the doors are completely closed.
- The product is set to a very low temperature. >>> Set the temperature of the product to a higher degree and wait for it to reach this temperature.

- Soğutucu ya da dondurucu kapı contası kirlenmiş, eskimiş, kırılmış ya da tam oturmamış olabilir. >>> Contayı temizleyin ya da değiştirin. Hasarlı / kopuk kapı contası ürünün mevcut sıcaklığı korumak için daha uzun süre çalışmasına neden olur.

Dondurucu sıcaklığı çok düşük ama soğutucu sıcaklığı yeterli.

- Dondurucu bölme sıcaklığı çok düşük bir değere ayarlanmıştır. >>> Dondurucu bölme sıcaklığını daha yüksek bir dereceye ayarlayıp kontrol edin.

Soğutucu sıcaklığı çok düşük ama dondurucu sıcaklığı yeterli.

- Soğutucu bölme sıcaklığı çok düşük bir değere ayarlanmıştır. >>> Soğutucu bölme sıcaklığını daha yüksek bir dereceye ayarlayıp kontrol edin.

Soğutucu bölme çekmecelerinde saklanan yiyecekler donuyor.

- Soğutucu bölme sıcaklığı çok düşük bir değere ayarlanmıştır. >>> Soğutucu bölme sıcaklığını daha yüksek bir değere ayarlayıp kontrol edin.

Soğutucu ya da dondurucudaki sıcaklık çok yüksek.

- Soğutucu bölme sıcaklığı çok yüksek bir değere ayarlanmış olabilir. >>> Soğutucu bölme sıcaklık ayarının dondurucu bölme sıcaklığı üzerinde etkisi vardır. Soğutucu ya da dondurucu bölme sıcaklığını değiştirerek ilgili bölmelerin sıcaklığı yeterli seviyeye gelene kadar bekleyin.
- Kapılar sık açılmış ya da uzun süre açık kalmıştır. >>> Kapıları çok sık açmayın.
- Kapı aralık olabilir. >>> Kapıyı tamamen kapatın.
- Ürünün fişi daha yeni takılmış ya da yeni yiyecek konulmuş olabilir. >>> Bu normaldir. Fiş yeni takıldığında ya da yeni yiyecek konulduğunda ürünün ayarlanan sıcaklığa ulaşması normalden daha uzun zaman alır.
- Ürüne yakın zamanda fazla miktarlarda sıcak yemek konmuş olabilir. >>> Ürüne sıcak yemek koymayın.

Sarsılma ya da gürültü.

- Zemin düz veya dayanıklı değildir. >>> Ürün yavaşça hareket ettirildiğinde sallanıyorsa ayaklarını ayarlayarak ürünü dengeleyin. Ayrıca zeminin ürünü taşıyabilecek kadar dayanıklı olmasına dikkat edin.
- Ürünün üzerine konan eşyalar gürültü yapıyor olabilir. >>> Ürünün üzerinde bulunan eşyaları kaldırın.
- Üründen sıvı akması, püskürmesi vb. sesler geliyor.
- Ürünün çalışma prensipleri gereği sıvı ve gaz akışları gerçekleşmektedir. >>> Bu normaldir ve bir arıza değildir.

Üründen rüzgar sesi geliyor.

- Ürünün soğutma işlemini gerçekleştirebilmesi için fan kullanılmaktadır. Bu normaldir ve bir arıza değildir.

Ürünün iç duvarlarında terleme oluyor.

- Havanın sıcak ve nemli olması buzlanmayı ve yoğunlaşmayı artırır. Bu normaldir ve bir arıza değildir.
- Kapılar sık açılmış ya da uzun süre açık kalmıştır. >>> Kapıları çok sık açmayın, açıksa kapatın.
- Kapı aralık olabilir. >>> Kapıyı tamamen kapatın.

Ürünün dışında ya da kapıların arasında terleme oluşuyor.

- Hava nemli olabilir, nemli havalarda bu gayet normaldir. >>> Nem azaldığında yoğunlaşma kaybolur.

Ürünün içi kötü kokuyor.

- Düzenli temizlik yapılmamıştır. >>> Ürünün içini sünger, ılık su veya karbonatlı suyla düzenli olarak temizleyin.
- Some containers or packaging materials may cause odor. >>> Use containers or packaging materials that do not cause odor.
- Foods are placed in open containers. >>> Store food in closed containers. Microorganisms spread from foods stored with their lids open may cause bad odors.
- Remove expired and spoiled foods from the product.

The door does not close.

- Food packages may be blocking the door from closing. >>> Move the packages that are blocking the doors.
- The product may not be standing completely upright on the floor. >>> Balance the product by adjusting its feet.
- The ground is not flat or solid. >>> Make sure the ground is flat and strong enough to support the product.

The vegetable bins are stuck.

- Food may be touching the top of the drawer. >>> Organize food in the drawer.

There is heat on the product surface.

- While your product is operating, high temperatures may be observed between the two doors, on the side panels and in the rear grill area. This is normal and does not require any service.

The fan continues to run when the door is opened.

- The fan may continue to run when the freezer door is opened.

WARNING



WARNING: If you cannot solve the problem despite following the instructions in this section, contact the dealer or Authorized Service where you purchased the product. Do not try to repair the non-functioning product yourself. This is a normal situation.
