

Grill and Toaster

User Manual



TM 6046 C / TM 6046 CS / TM 6046 CK

EN



01M-8818041100-5021-04
01M-8817731100-5021-04
01M-8817721100-5021-04

Please read this guide first!

Dear Customer,

We would like you to achieve the optimal efficiency from this high quality product which has been manufactured with the state of the art technology. Please make sure you read and understand this guide and supplementary documentation fully before use and keep it as a reference. Include this guide with the unit if you hand it over to someone else. Observe all warnings and information herein and follow the instructions.

Symbols and their meanings

Following symbols have been used throughout this guide:



Important information and beneficial advices regarding the usage of the device.



WARNING: Warnings about hazards to life and property.



Suitable for contact with food.



Warning of electric shock.



Warning about hot surfaces.



**RECYCLED &
RECYCLABLE
PAPER**

This product has been produced in environmentally-friendly, state-of-the-art facilities.

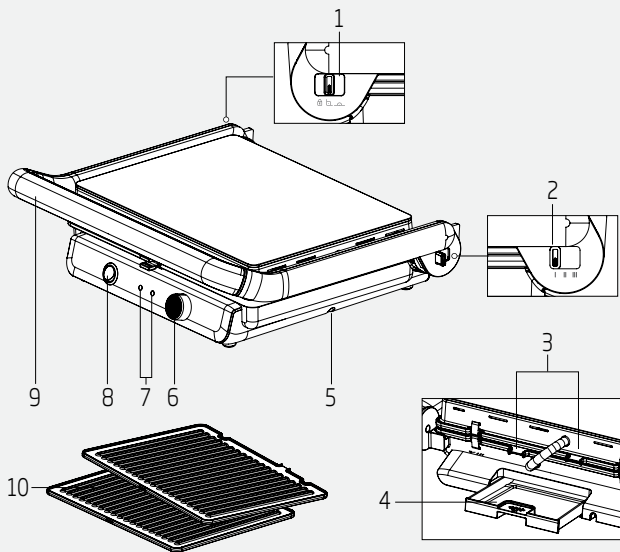

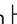
1. Locking bolt
(Off , Half on , On )

2. Level adjustment slider (I - II - III)

3. Oil drainage channel (2)

4. Removable oil collection container

5. Cable winding slot (under the device)

6. Thermostat button

7. Status indicator lights

8. On/Off switch

9. Handle

10. Removable cooking plates (2)

Technical data

Power supply:

230 V ~, 50-60 Hz

Power: 2400 W

The right to make technical and design changes is reserved.

The values provided with the appliance or its accompanying documents are laboratory readings in accordance with the respective standards. These values may differ depending on the use and ambient conditions.

CONTENTS

1 Important safety and environmental instructions 5

- 1.1 General safety5
- 1.2 Compliance with the WEEE regulations and waste disposal9
- 1.3 Packaging information9
- 1.4 What to do for energy saving ...9

2 Operation 10

- 2.1 Intended use..... 10
- 2.2 First operation 10
- 2.3 Operation 10
- 2.4 Toasting and grilling 11
- 2.5 Appliance turned off 15
- 2.6 Removing / installing the plates15

3 Cleaning and maintenance 16

- 3.1 Cleaning..... 16
- 3.2 Storage 18
- 3.3 Transportation and shipping... 18

1 Important safety and environmental instructions

This section contains safety instructions to prevent hazards that can result in injury or property damage.

Any warranty is void if these instructions are not followed.

1.1 General safety

- This appliance complies with international safety standards.
- The device is not for commercial use, it is only suitable for domestic use.
- This device is aimed to be used in household and similar applications such as the places specified below:
 - Staff kitchen areas in shops, offices and other working environments,
 - Farm houses,
 - Places used by customers in motels, hotels and other residential-type environments,
 - Bedrooms and breakfast locations.
- Appliance may be used by children above age of 8, persons with limited physical, perceptual or mental abilities or persons with a lack of experience and knowledge if they are supervised or given

1 Important safety and environmental instructions

instructions on the operation of the appliance and any relevant risks they may encounter. Children should not tamper with the appliance.

- Cleaning and user maintenance should not be carried out by children unless they are over 8 years of age and under supervision.
- Keep the appliance and its cable out of the reach of children under 8 years of age.
- Do not use the appliance if the power cord or the appliance is damaged. Contact authorised service.
- Your mains power supply should be in align with the specified information on the type tag of the appliance.
- For additional protection, this device must be connected to a residual current device with a maximum rated value of 30 mA.
- Use the appliance in a grounding plug.
- Do not use the appliance with an extension cord.
- To prevent damage to the power cord, prevent it from being pinched, crimped or rubbed against sharp edges.
- Do not touch the plug of the appliance while your

1 Important safety and environmental instructions

hands are damp or wet.

- Do not immerse the appliance or its power cord in water.
- Do not leave the appliance unattended while it is plugged in.
- The outer surface heats up during use. To avoid the risk of burns, do not touch hot surfaces.
- Do not leave metal cooking utensils and utensils on the cooking plates.
- Use and store the appliance on a secured surface.
- Do not disassemble the appliance.
- Use only original parts or parts recommended by the manufacturer.
- Unplug the appliance before cleaning and dry all parts completely after cleaning.
- Clean only the outer surface and plates according to the instructions in the Cleaning and Maintenance section.
- The appliance is not suitable for outdoor use.
- Do not operate the appliance with an external timer

1 Important safety and environmental instructions

or a separate remote control system.

- Food may catch fire due to overheating. Do not allow the appliance to come into contact with or be covered by flammable materials such as curtains, fabrics, walls, etc.
- Do not use the appliance in or near explosive or flammable environments and substances.
- Charcoal or similar combustible fuels must not be used in this appliance.
- If you keep the packaging materials, keep them out of the reach of children.

1.2 Compliance with the WEEE regulations and waste disposal



This product does not contain the dangerous and prohibited materials indicated in "Waste Electrical and Electronic Equipment Control Regulation" published by Ministry of Environment and Urbanisation of the Republic of Turkey. Complies with WEEE Regulations. This product was manufactured from recyclable and reusable high quality parts and materials. Therefore, do not dispose of this product with other domestic wastes at the end of its life cycle. Take it to a collection point for recycling of electrical and electronic equipment. You can ask your local administration about these collection points. You can help protect the environment and natural resources by delivering the used products for recycling.

1.3 Packaging information



The product's packaging is made of recyclable materials, in accordance with the National Legislation. Do not dispose of the packaging waste with the household waste or other wastes, dispose it to the packaging collection areas specified by local authorities.

1.4 What to do for energy saving

Turn off and unplug the appliance after each use. Choose appropriate temperatures when cooking your food.

2 Operation

2.1 Intended use

This appliance is intended for home use and food preparation only, it is not suitable for professional use.

2.2 First operation

When using the product for the first time, it is recommended to run it for 15 minutes at maximum temperature without adding food. A slight smoke is normal and will disappear after a short time.

2.3 Operation

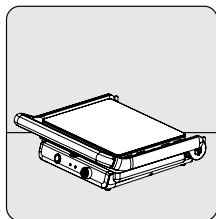

Place the device on a flat surface.

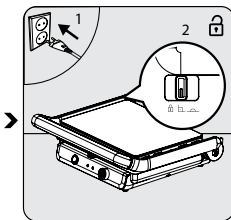

Push the locking slide (1) to the half-open "L" position.

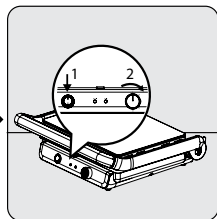

To start the appliance, turn the On/Off switch (8) to the "I" position. Set the thermostat knob (6) to the position you want to cook.



WARNING: Make sure that both cooking plates are inserted before switching on the appliance.

2 Operation

2.4 Toasting and grilling



You can adjust the level adjustment slider to I - II - III according to the thickness of the food.

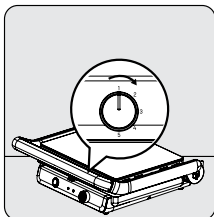

Set the thermostat knob (6) to the position you want to cook.

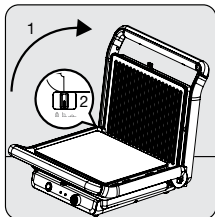

Lift the top cover of the appliance slightly and move the locking slide (1) to the half-open "□" position. Open the top cover of the appliance upwards by holding the handle (9).

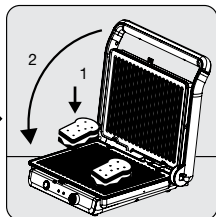

Place the food you will cook on the cooking plate (10). Close the top cover of the appliance downwards by holding the handle (9).

2 Operation

Device plates in closed position

This position is suitable for grilling using the upper and lower cooking plates in the closed position. It should be preferred for sandwiches, toast, pancakes, hamburgers, etc.

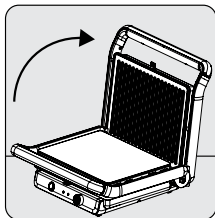

Open the top cover of the appliance upwards by holding the handle (9).

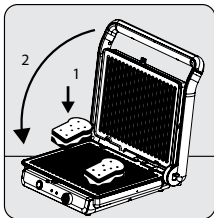

Place the food you will cook on the cooking plate (10).

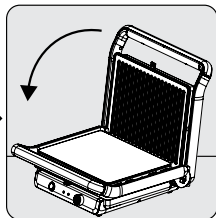

Close the top cover of the appliance downwards by holding the handle (9).

Appliance plates in grill oven position

In this position the grills will not touch each other. It should be preferred for foods that are not desired to be pressed, such as open toast, but are desired to receive heat from the top.

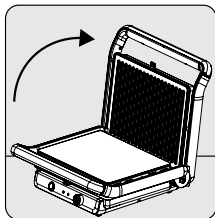

Open the top cover of the appliance upwards by holding the handle (9).

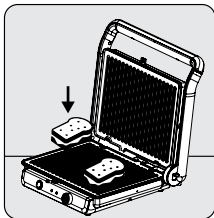

Place the food you will cook on the cooking plate (10).

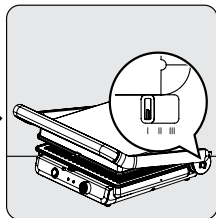

Set the level adjustment slider (2) to the desired level (I - II - III) and close the top handle (9) downwards.

2 Operation

Device plates in half-open position

The lower cooking plate must be used for cooking food.

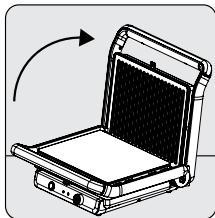

Open the top cover of the device by holding the handle (9).

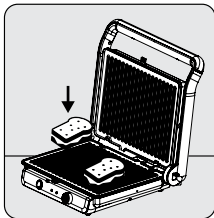

Place the food you will cook on the cooking plate (10).

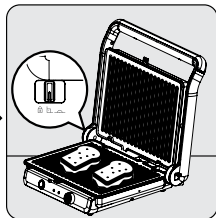

Leave the top cover of the appliance in the “□” position and cook.



WARNING: The top cooking plate is hot.

2 Operation

Two plates in horizontal position

This position provides two large grill areas. It should be preferred for foods that need to be cooked by heating from one surface.

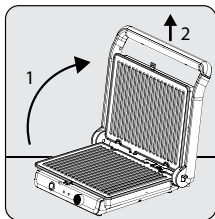

Open the top cover of the device by holding the handle (8). Then pull it upwards.

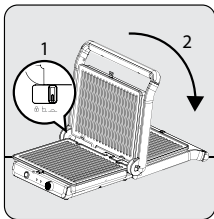

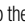
Move the top cover of the appliance to the “” symbol and tilt it backwards to a horizontal position.

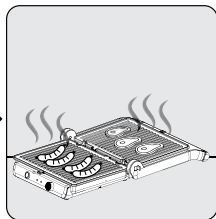

Place the food to be cooked (sausages, steaks, etc.) on the cooking plate (4).



To grill, turn the thermostat knob (6) to position "5".



WARNING: Use utensils made of wood or heat-resistant plastic to turn or remove food from the cooking plates.



WARNING: Be very careful when removing food from the appliance, the metal parts of the appliance and the food may be very hot.

2 Operation

2.5 Appliance turned off

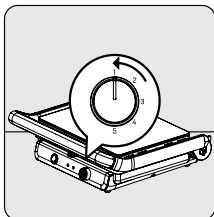

Turn the thermostat knob (6) to position "1".

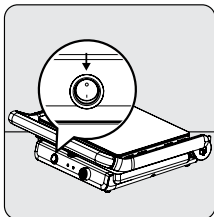

To turn off the appliance, turn the On/Off switch (8) to the "0" position.

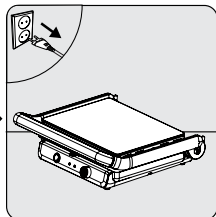

Unplug the appliance from the mains and allow it to cool down.

2.6 Removing / installing the plates



WARNING: Before touching the cooking plates, make sure that the appliance has cooled down completely. Do not touch the cooking plates when they are hot.

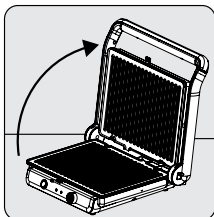

Open the top cover of the device by holding the handle (9).

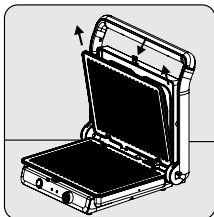

Press the plate locking latches on the front of the upper and lower cooking plates (10) and lift up slightly to remove the plates.

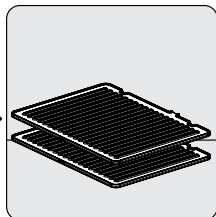

To reinsert the cooking plates (10), insert the cooking plates into the slots on the inside back of the appliance and snap them into place.

3 Cleaning and maintenance

3.1 Cleaning

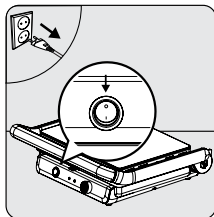

To turn off the appliance, turn the On/Off switch (8) to the "0" position and unplug it.

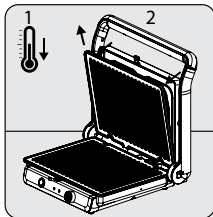

Wait for the appliance to completely cool down. Remove the cooking plates (10).

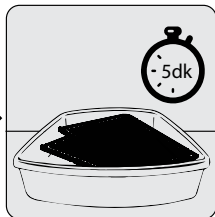

Soak the cooking plates (10) in warm water for about 5 minutes.



They can then be cleaned with liquid dishwashing detergent and a sponge with a soft surface.

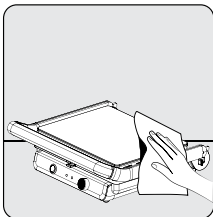

Use a damp cloth to clean the outer surface of the appliance. Dry the outside of the appliance completely.



Water or moisture must never get into the electrical areas.



WARNING: Do not wash the cooking plates in the dishwasher.

3 Cleaning and maintenance



After cleaning, dry all parts before using the appliance.



WARNING: White water stains may appear on plates left wet.



WARNING: Never use gasoline, solvent, abrasive cleaners, metal objects or hard brushes to clean the appliance.



Clean the device after each use to keep it well maintained.



WARNING: For easier cleaning, it is recommended to clean the plates after each cooking process after they have cooled down.

3 Cleaning and maintenance

3.2 Storage

- Unplug the appliance and allow it to cool before storing it.
- Close the appliance door by holding it by the handle (9).
- Pull the locking adjustment slide of the device to the “” position.
- If you do not intend to use the device for a long time, store it carefully.
- Store the appliance in a cool dry place.
- Wrap the appliance cable around the cable winding slot (5) on the bottom of the appliance.
- Keep the appliance out of the reach of children.

3.3 Transportation and shipping

- During transportation and shipping, carry the appliance with its original packaging. The packaging of the appliance will protect the appliance against physical damage.
- Do not place heavy objects on the device or its packaging. The appliance may get damaged.
- If the appliance is dropped, the appliance may not operate or permanent damage may occur.